

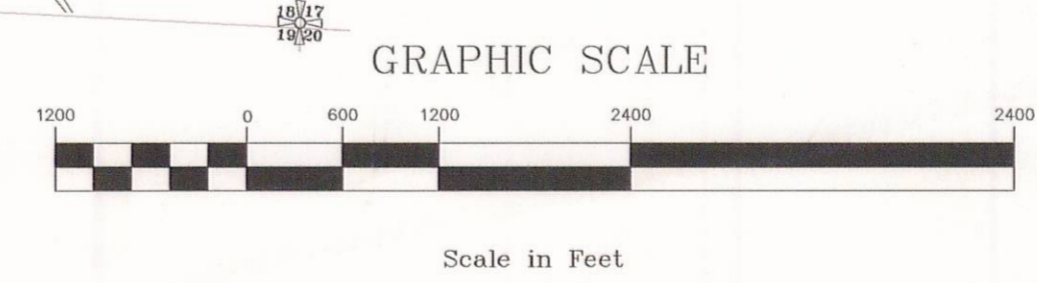

APPROVED WETLANDS INVENTORY
 Oregon Division of State Lands
 Meets LWZ standards
 Date 7/02 Approved by J. Medan

LEGEND	
Watershed Boundary	--- --
Coastal Shorelands Planning Area (Goal 17)	--- --
Drainage	--- --
Urban Growth Boundary	--- --
Riparian Observation Point	☀
Riparian Code	R-H-2
Upland	∩
Affected Taxlot	□
Potentially Jurisdictional Wetland	□
Major Marsh (Goal 17)	□
Locally Significant Wetland (Goal 5)	□
Riparian Area	□
Wetland Code	R0-1
Sample Point	●



Funding for this project was provided by a grant from the Oregon Department of Land Conservation and Development

THIS MAP IS FOR PLANNING PURPOSES ONLY
 WETLAND BOUNDARIES ARE APPROXIMATE
 AND SUBJECT TO CHANGE

This map has NOT been approved by the wetland regulatory agencies for permitting purposes. You are advised to contact the Oregon Division of State Lands and the U.S. Army Corps of Engineers with any regulatory questions. There may be additional wetlands within the study area that have not been identified. All wetlands, whether mapped or not, are subject to Federal and State permit requirements. There may also be areas of non-wetland within areas identified as wetlands on this map. In all cases, Federal and State agencies will use actual field conditions, rather than this map, to determine wetland boundaries.

DATE: June, 2001
 BASE MAP INFO: Supplied by City of Gold Beach,
 DOGAMI, BLM 1997 Aerial Photographs
 JOB NO.: 2316

Gold Beach

Local Wetlands and Riparian Inventory

Pacific Habitat Services, Inc.
 9450 SW Commerce Circle, Suite 180
 Wilsonville, Oregon 97070
 Phone: (503) 570-0800

Reference
 Sheet:

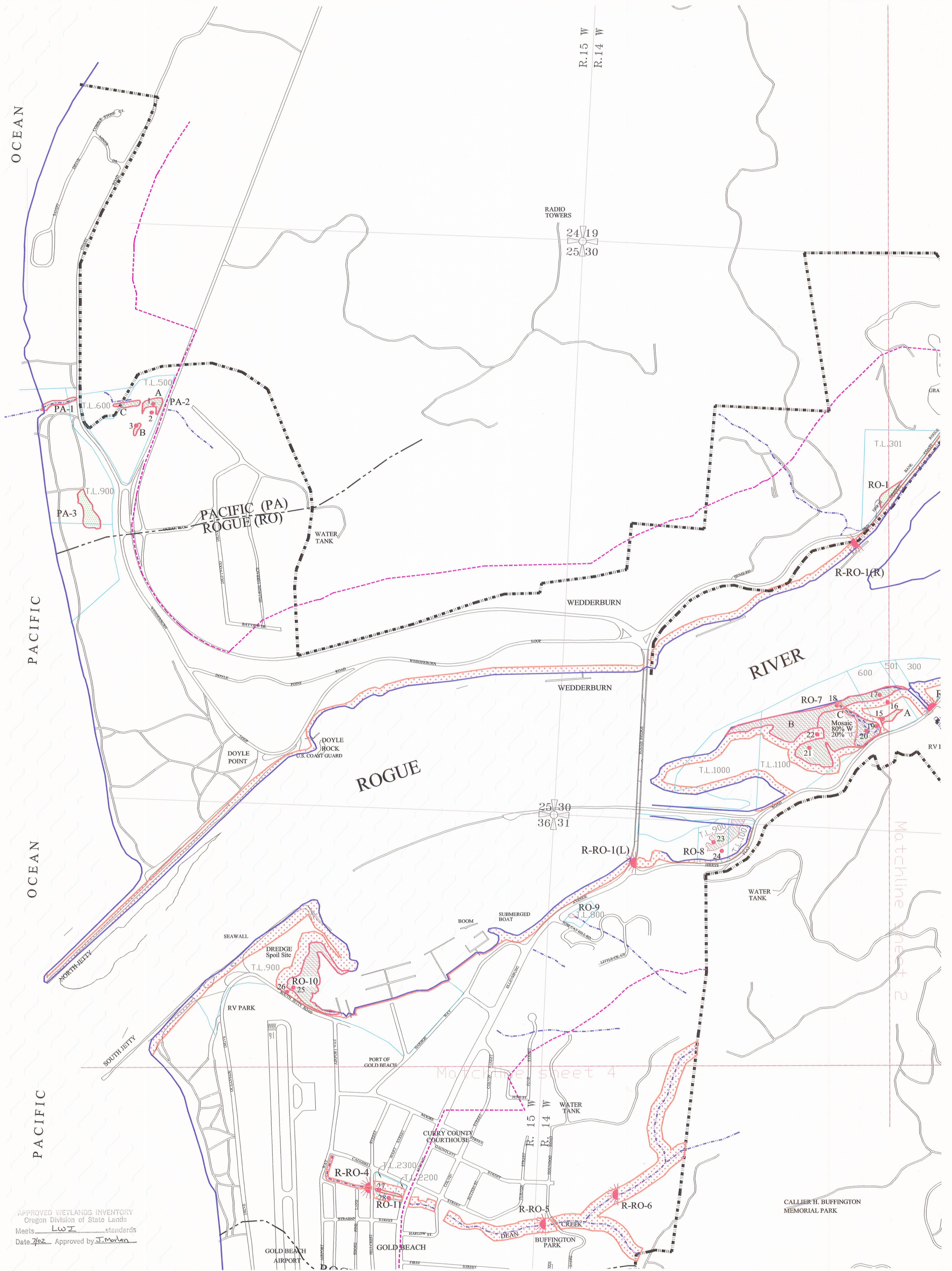

APPROVED WETLANDS INVENTORY
Oregon Division of State Lands
Meets LOW standards
Date 7/02 Approved by J. Moran

LEGEND

Watershed Boundary	---	Affected Taxlot	□
Coastal Shorelands Planning Area (Goal 17)	---	Potentially Jurisdictional Wetland	□
Drainage	---	Major Marsh (Goal 17)	□
Urban Growth Boundary	---	Locally Significant Wetland (Goal 5)	□
Riparian Observation Point	☀	Riparian Area	□
Riparian Code	R-H-2	Wetland Code	RO-1
Upland	∩	Sample Point	● 20

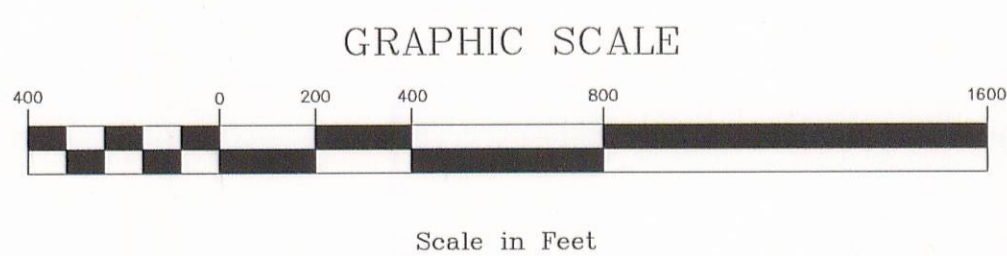

Funding for this project was provided by a grant from the Oregon Department of Land Conservation and Development

THIS MAP IS FOR PLANNING PURPOSES ONLY
WETLAND BOUNDARIES ARE APPROXIMATE
AND SUBJECT TO CHANGE

This map has NOT been approved by the wetland regulatory agencies for permitting purposes. You are advised to contact the Oregon Division of State Lands and the U.S. Army Corps of Engineers with any regulatory questions. There may be additional wetlands within the study area that have not been identified. All wetlands, whether mapped or not, are subject to Federal and State permit requirements. There may also be areas of non-wetland within areas identified as wetlands on this map. In all cases, Federal and State agencies will use actual field conditions, rather than this map, to determine wetland boundaries.

DATE: June, 2001
BASE MAP INFO: Supplied by City of Gold Beach,
DOGAMI, BLM 1997 Aerial Photographs
JOB NO.: 2316

Gold Beach

Local Wetlands and Riparian Inventory

Pacific Habitat Services, Inc.
9450 SW Commerce Circle, Suite 180
Wilsonville, Oregon 97070
Phone: (503) 570-0800



Sheet: 1

of: 5

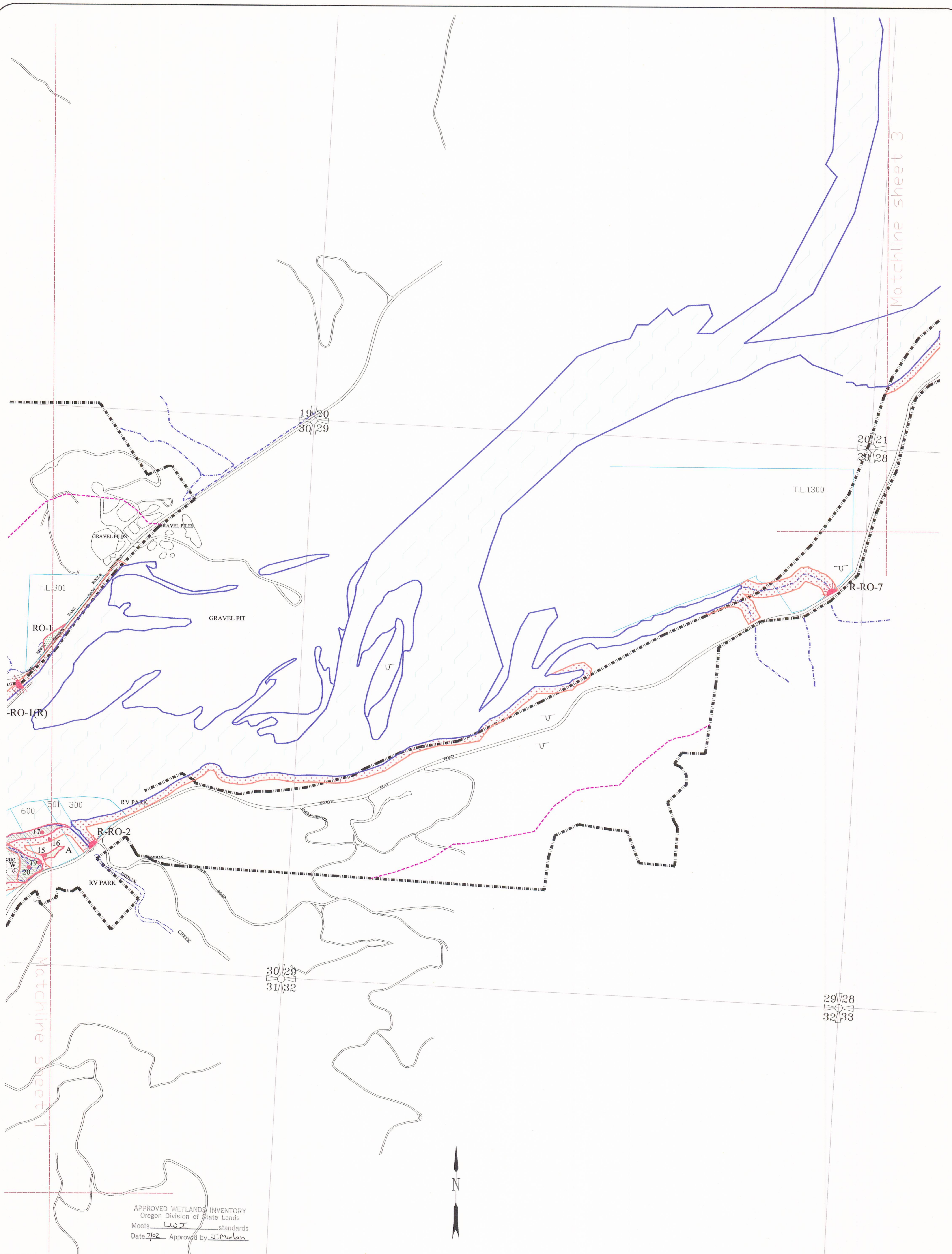

APPROVED WETLANDS INVENTORY
 Oregon Division of State Lands
 Meets LWI standards
 Date 7/02 Approved by J. Moran

LEGEND		
Watershed Boundary	--- --	Affected Taxlot
Coastal Shorelands Planning Area (Goal 17)	--- --	Potentially Jurisdictional Wetland
Drainage	--- --	Major Marsh (Goal 17)
Urban Growth Boundary	--- --	Locally Significant Wetland (Goal 5)
Riparian Observation Point	☀	Riparian Area
Riparian Code	R-H-2	Wetland Code
Upland	U	Sample Point
		RO-1

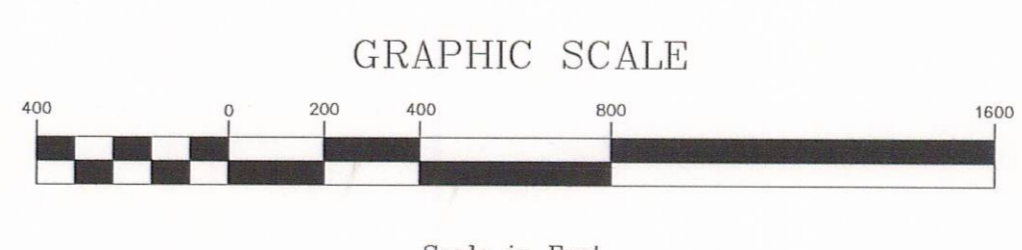

Funding for this project was provided by a grant from the Oregon Department of Land Conservation and Development

THIS MAP IS FOR PLANNING PURPOSES ONLY
 WETLAND BOUNDARIES ARE APPROXIMATE
 AND SUBJECT TO CHANGE
 This map has NOT been approved by the wetland regulatory agencies for permitting purposes. You are advised to contact the Oregon Division of State Lands and the U.S. Army Corps of Engineers with any regulatory questions. There may be additional wetlands within the study area that have not been identified. All wetlands, whether mapped or not, are subject to Federal and State permit requirements. There may also be areas of non-wetland within areas identified as wetlands on this map. In all cases, Federal and State agencies will use actual field conditions, rather than this map, to determine wetland boundaries.

DATE: June, 2001
 BASE MAP INFO: Supplied by City of Gold Beach,
DOGAMI, BLM 1997 Aerial Photographs
 JOB NO.: 2316

Gold Beach

Local Wetlands and Riparian Inventory

Pacific Habitat Services, Inc.
 9450 SW Commerce Circle, Suite 180
 Wilsonville, Oregon 97070
 Phone: (503) 570-0800



Sheet: 2
 of: 5

16/15

17/16
20/21

16/15
21/22

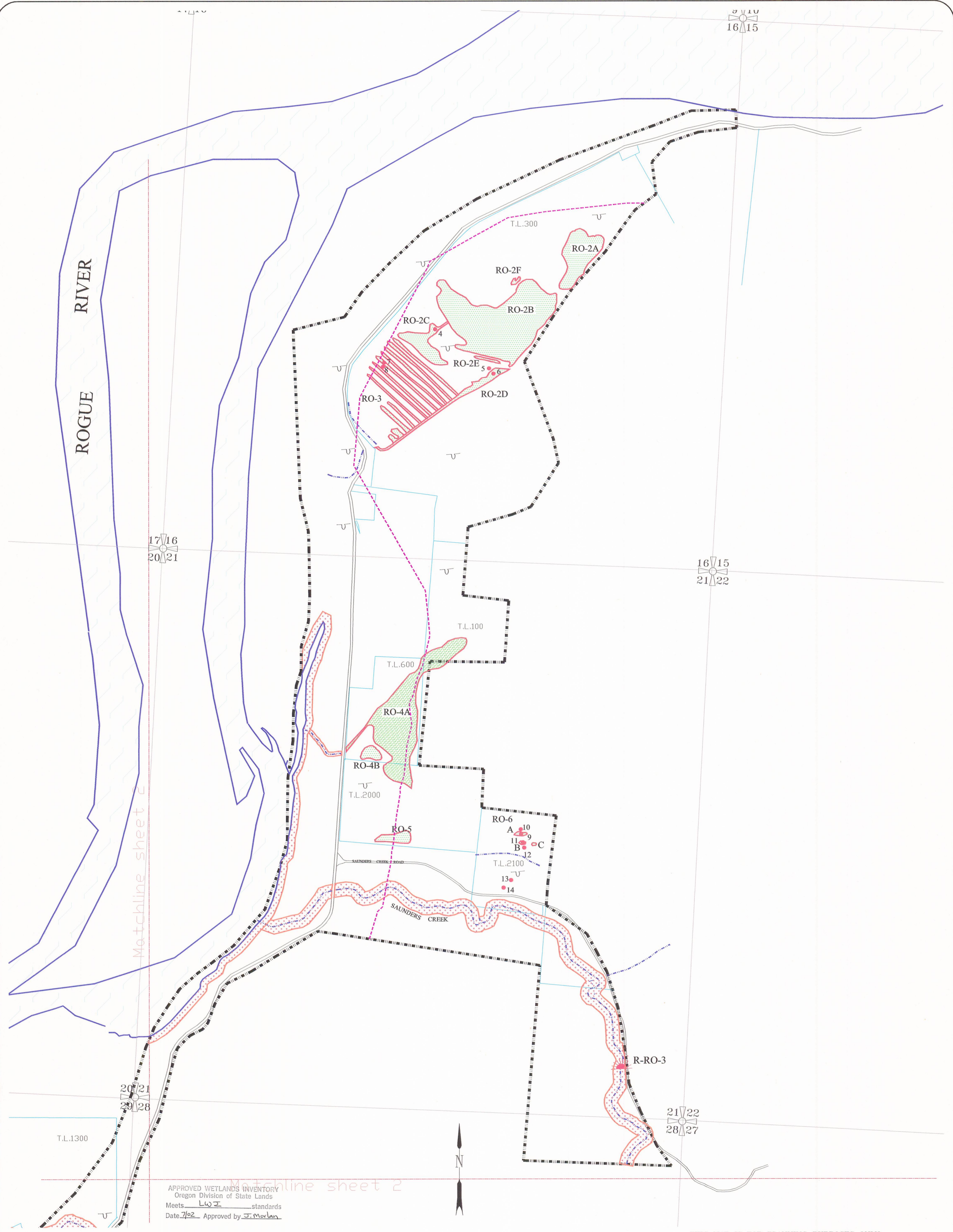

APPROVED WETLANDS INVENTORY
 Oregon Division of State Lands
 Meets LW 2 standards
 Date 7/02 Approved by J. Moran

LEGEND

Watershed Boundary	Affected Taxlot	Potentially Jurisdictional Wetland
Coastal Shorelands Planning Area (Goal 17)	Major Marsh (Goal 17)	Locally Significant Wetland (Goal 5)
Drainage	Riparian Area	Wetland Code
Urban Growth Boundary	Riparian Code	RO-1
Riparian Observation Point	Upland	Sample Point
R-H-2		20

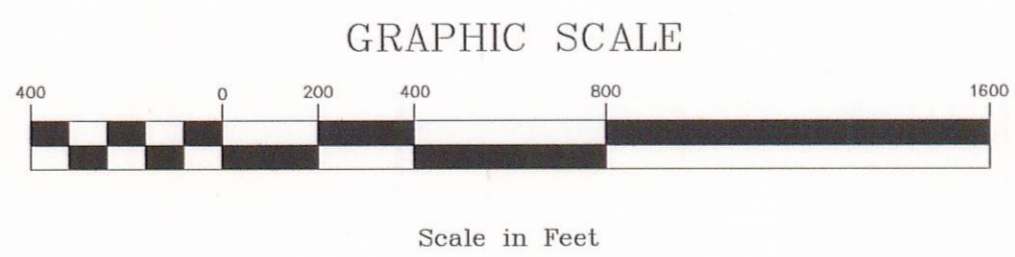

Funding for this project was provided by a grant from the Oregon Department of Land Conservation and Development

THIS MAP IS FOR PLANNING PURPOSES ONLY
 WETLAND BOUNDARIES ARE APPROXIMATE
 AND SUBJECT TO CHANGE

This map has NOT been approved by the wetland regulatory agencies for permitting purposes. You are advised to contact the Oregon Division of State Lands and the U.S. Army Corps of Engineers with any regulatory questions. There may be additional wetlands within the study area that have not been identified. All wetlands, whether mapped or not, are subject to Federal and State permit requirements. There may also be areas of non-wetland within areas identified as wetlands on this map. In all cases, Federal and State agencies will use actual field conditions, rather than this map, to determine wetland boundaries.

DATE: June, 2001
 BASE MAP INFO: Supplied by City of Gold Beach,
 DOGAMI, BLM 1997 Aerial Photographs
 JOB NO.: 2316

Gold Beach

Local Wetlands and Riparian Inventory

Pacific Habitat Services, Inc.
 9450 SW Commerce Circle, Suite 180
 Wilsonville, Oregon 97070
 Phone: (503) 570-0800

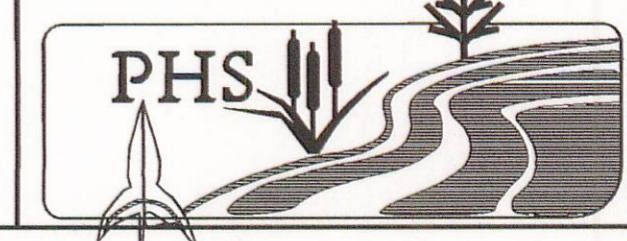

Sheet: 3

of: 5

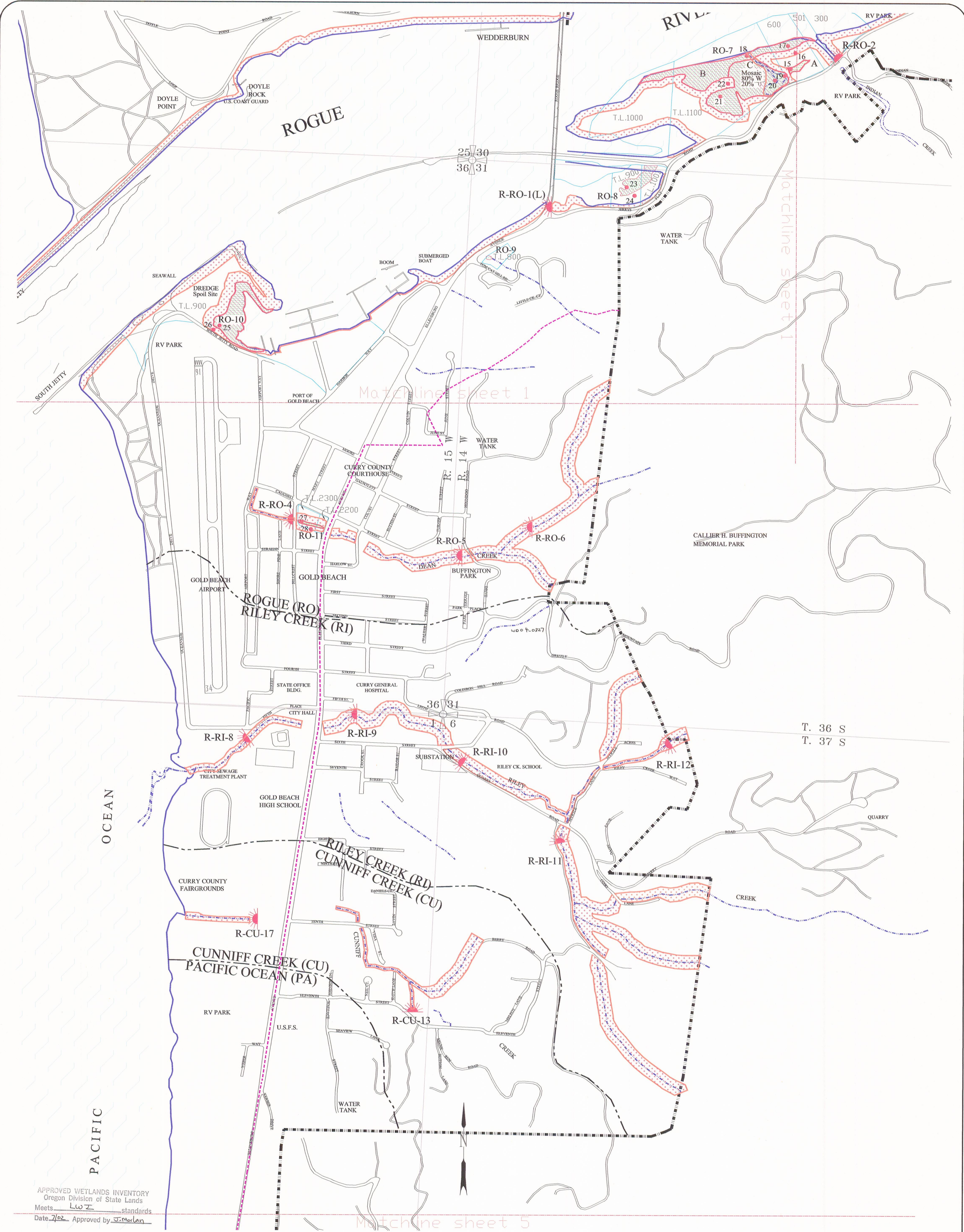

APPROVED WETLANDS INVENTORY
Oregon Division of State Lands
Meets LWZ standards
Date: 7/02 Approved by J. Melan

LEGEND	
Watershed Boundary	Affected Taxlot
Coastal Shorelands Planning Area (Goal 17)	Potentially Jurisdictional Wetland
Drainage	Major Marsh (Goal 17)
Urban Growth Boundary	Locally Significant Wetland (Goal 5)
Riparian Observation Point	Riparian Area
Riparian Code	Wetland Code
Upland	Sample Point

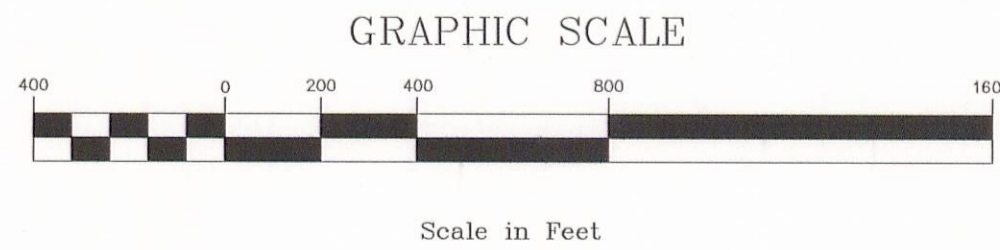

Funding for this project was provided by a grant from the Oregon Department of Land Conservation and Development

THIS MAP IS FOR PLANNING PURPOSES ONLY
WETLAND BOUNDARIES ARE APPROXIMATE
AND SUBJECT TO CHANGE

This map has NOT been approved by the wetland regulatory agencies for permitting purposes. You are advised to contact the Oregon Division of State Lands and the U.S. Army Corps of Engineers with any regulatory questions. There may be additional wetlands within the study area that have not been identified. All wetlands, whether mapped or not, are subject to Federal and State permit requirements. There may also be areas of non-wetland within areas identified as wetlands on this map. In all cases, Federal and State agencies will use actual field conditions, rather than this map, to determine wetland boundaries.

DATE: June, 2001
BASE MAP INFO: Supplied by City of Gold Beach,
DOGAMI, BLM 1997 Aerial Photographs
JOB NO.: 2316

Gold Beach

Local Wetlands and Riparian Inventory

Pacific Habitat Services, Inc.
9450 SW Commerce Circle, Suite 180
Wilsonville, Oregon 97070
Phone: (503) 570-0800

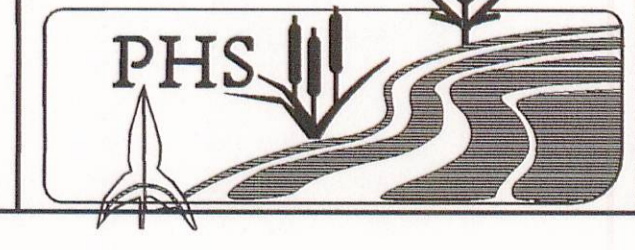

Sheet: 4
of: 5

Match the sheet 4

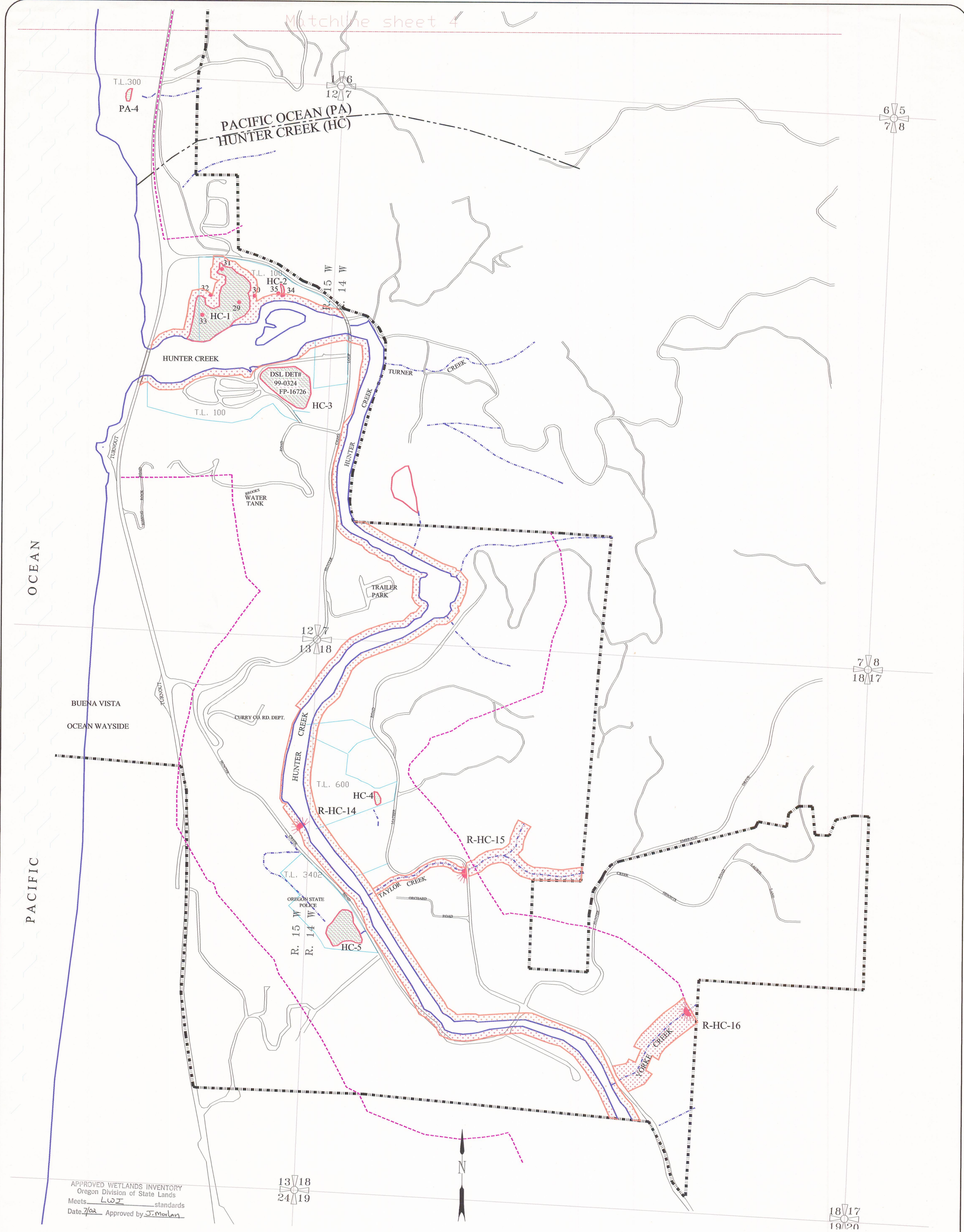

APPROVED WETLANDS INVENTORY
Oregon Division of State Lands
Meets LWJ standards
Date 7/02 Approved by J. Moran

LEGEND	
Watershed Boundary	— — — — —
Coastal Shorelands Planning Area (Goal 17)	- - - - -
Drainage	— — — — —
Urban Growth Boundary	— — — — —
Riparian Observation Point	
Riparian Code	R-H-2
Upland	U
Affected Taxlot	
Potentially Jurisdictional Wetland	
Major Marsh (Goal 17)	
Locally Significant Wetland (Goal 5)	
Riparian Area	
Wetland Code	RO-1
Sample Point	

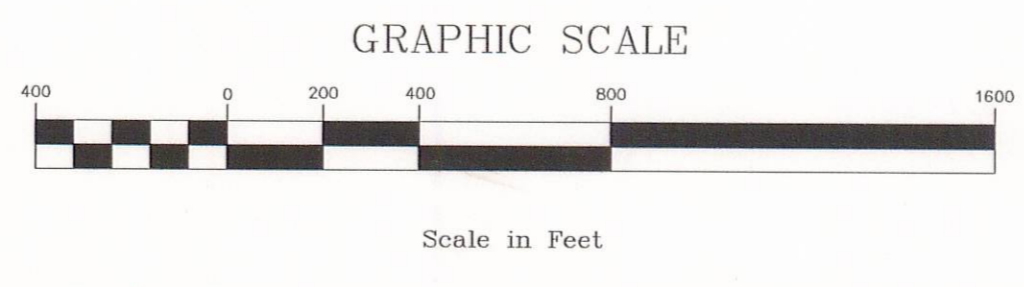

Funding for this project was provided by a grant from the Oregon Department of Land Conservation and Development

THIS MAP IS FOR PLANNING PURPOSES ONLY
WETLAND BOUNDARIES ARE APPROXIMATE
AND SUBJECT TO CHANGE

This map has NOT been approved by the wetland regulatory agencies for permitting purposes. You are advised to contact the Oregon Division of State Lands and the U.S. Army Corps of Engineers with any regulatory questions. There may be additional wetlands within the study area that have not been identified. All wetlands, whether mapped or not, are subject to Federal and State permit requirements. There may also be areas of non-wetland within areas identified as wetlands on this map. In all cases, Federal and State agencies will use actual field conditions, rather than this map, to determine wetland boundaries.

DATE: June, 2001
BASE MAP INFO: Supplied by City of Gold Beach,
DOGAMI, BLM 1997 Aerial Photographs
JOB NO.: 2316

Gold Beach

Local Wetlands and Riparian Inventory

Pacific Habitat Services, Inc.
9450 SW Commerce Circle, Suite 180
Wilsonville, Oregon 97070
Phone: (503) 570-0800

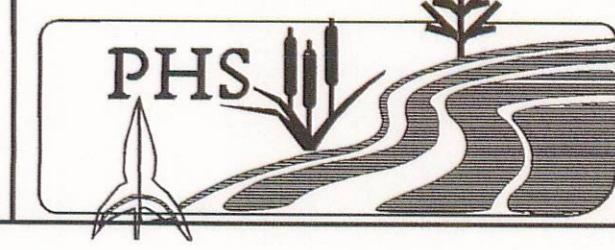

Sheet: 5
of: 5