

# CITY OF SANDY Local Wetland Inventory

- SR5/TCH Wetland/stream designator
- Intermittent Stream
- Urban Growth Boundary
- Potentially jurisdictional wetland area

**WETLAND INFORMATION IS SUBJECT TO CHANGE**

This map is for planning purposes only. It has not been finalized and adopted by the City of Sandy or approved by the wetland regulatory agencies. You are advised to contact the Oregon Division of State Lands or the U.S. Army Corps of Engineers with any regulatory questions. Mapped wetland boundaries were not flagged or surveyed, but are accurate to within 25 feet, and there may be unmapped wetlands subject to regulation. Some areas have been identified as potential wetlands and are located on the maps. In all cases, actual field conditions determine wetland boundaries.

APPROVED WETLANDS INVENTORY  
Oregon Division of State Lands  
Meets Local Wetlands Inventory standards  
Date 2-18-17 Approval by J. Morlan

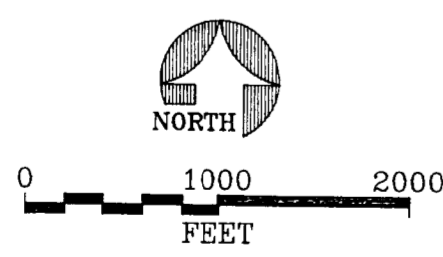
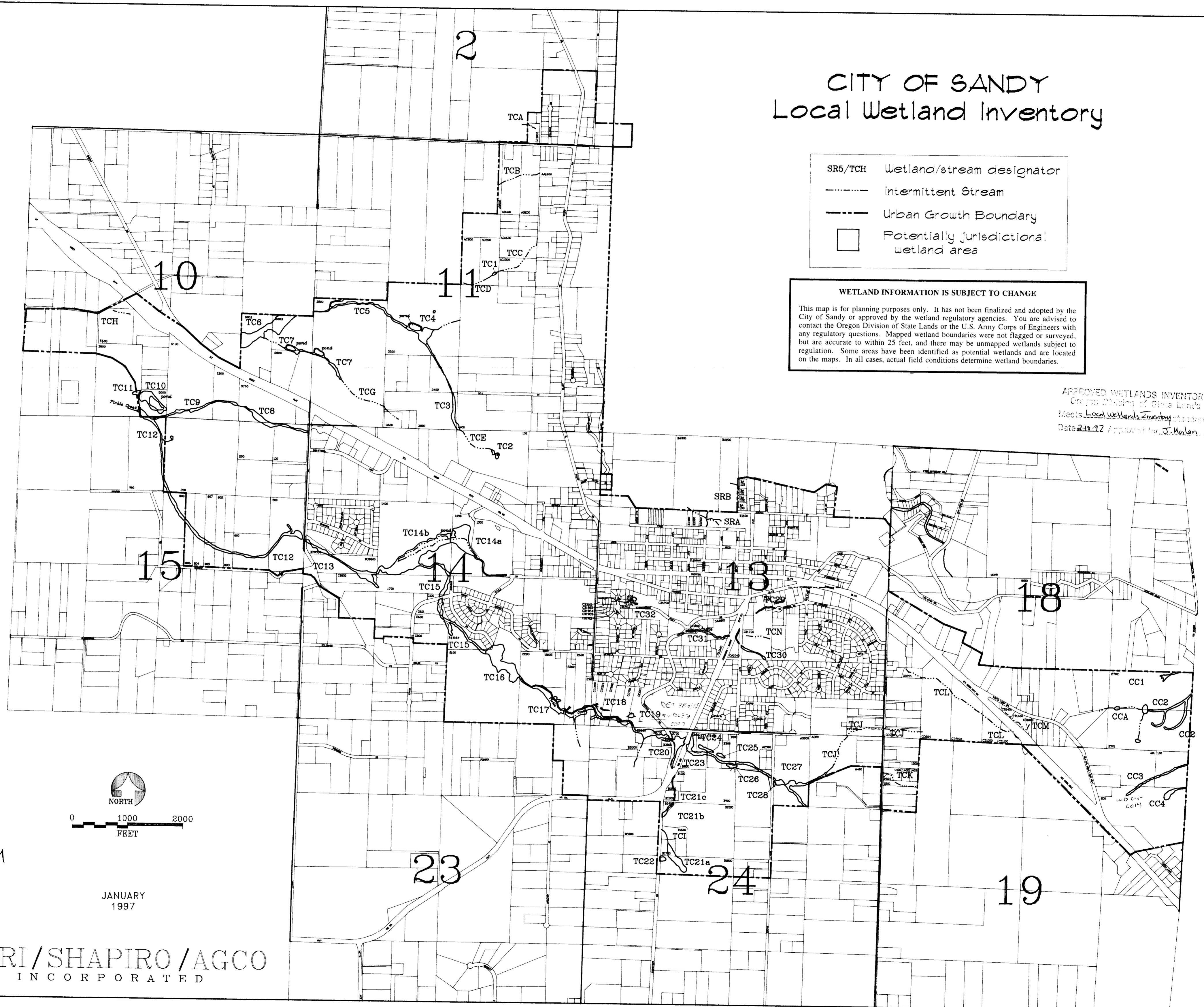

SANDY

JANUARY  
1997

T 2S R 4E Section 02

# CITY OF SANDY LOCAL WETLAND INVENTORY

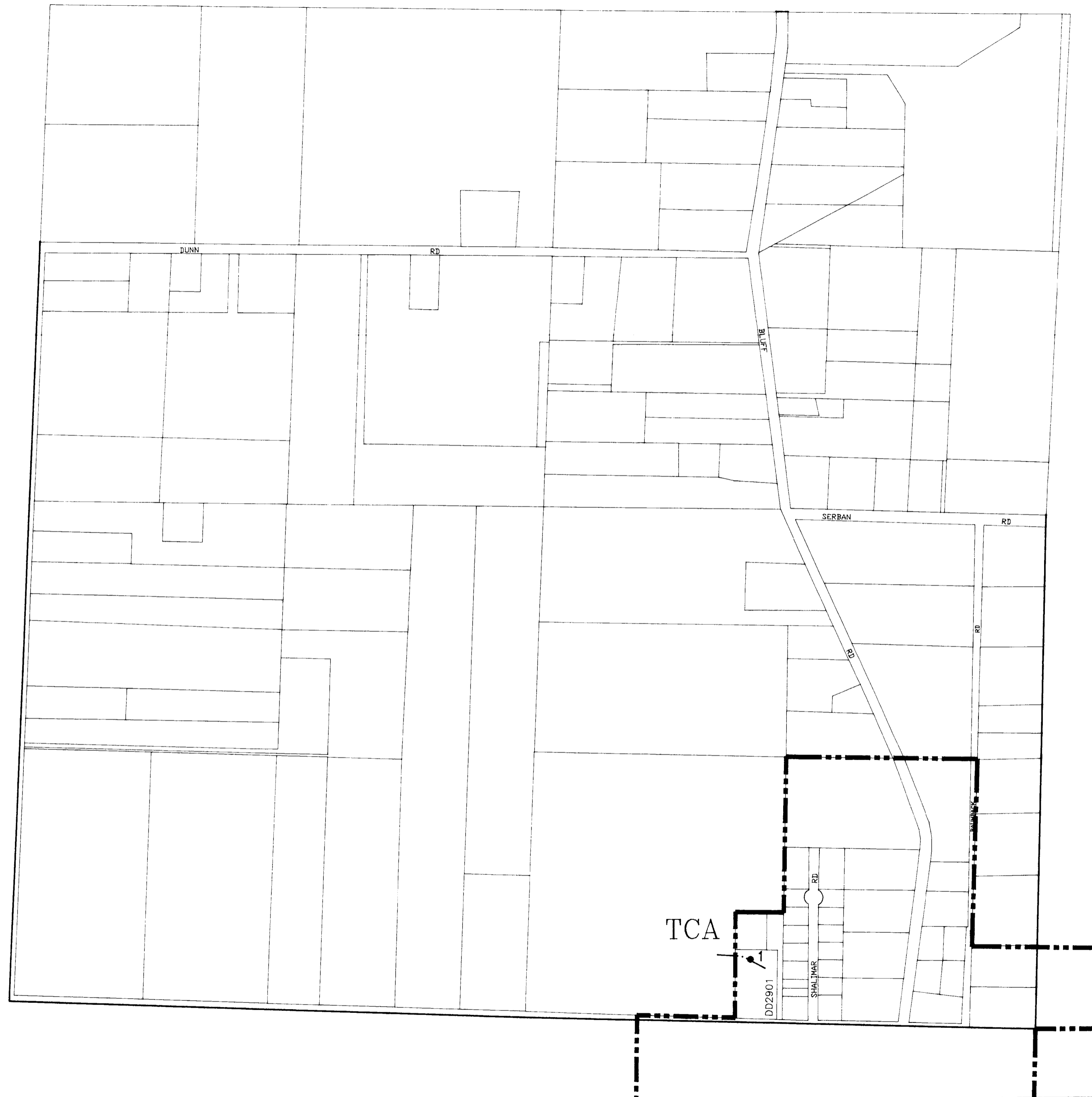

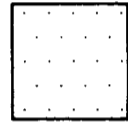
- <sup>8</sup> Sample site
- TC4 Wetland designator
- Urban Growth Boundary
-  Potentially jurisdictional wetland
- Intermittent Stream

 Wetland acreage

1 acre  
1/10th acre  
1/100th acre

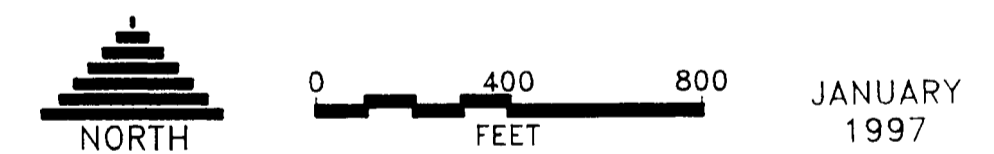

WETLAND INFORMATION IS SUBJECT TO CHANGE

This map is for planning purposes only. It has not been finalized and adopted by the City of Sandy or approved by the wetland regulatory agencies. You are advised to contact the Oregon Division of State Lands or the U.S. Army Corps of Engineers with any regulatory questions. Mapped wetland boundaries were not flagged or surveyed, but are accurate to within 25 feet, and there may be unmapped wetlands subject to regulation. Some areas have been identified as potential wetlands and are located on the maps. In all cases, actual field conditions determine wetland boundaries.

## City of Sandy

39250 Pioneer Boulevard  
Sandy, Oregon 97055

 SRI/SHAPIRO/AGCO  
INCORPORATED

APPROVED WETLANDS INVENTORY  
Oregon Division of State Lands  
Moe's Local Wetlands Inventory  
Date 2/1/17 Approved by J. Merden

T 2S R 4E Section 10

# CITY OF SANDY LOCAL WETLAND INVENTORY

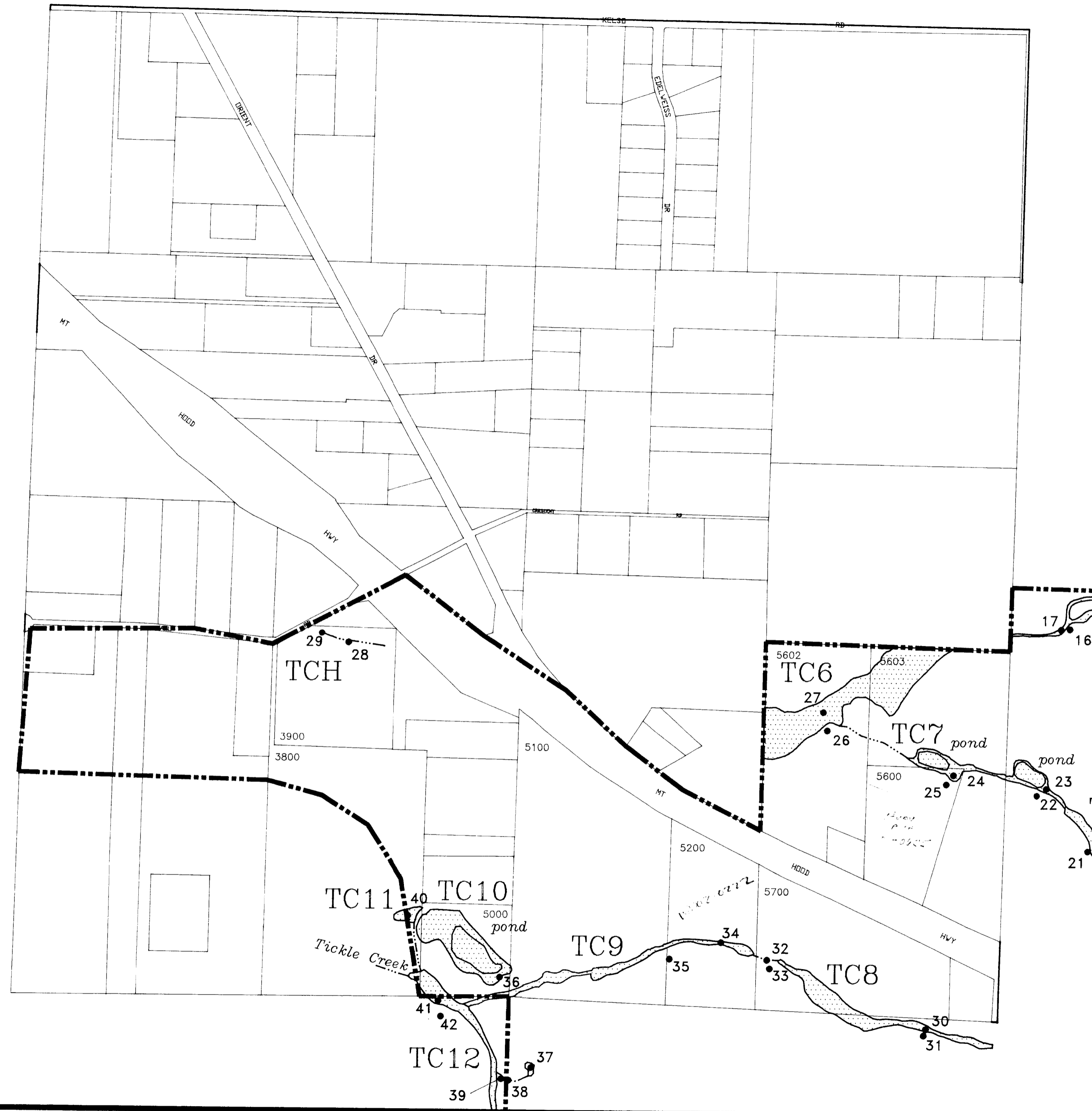

- 8 Sample site
- TC4 Wetland designator
- Urban Growth Boundary
- Potentially jurisdictional wetland
- Intermittent stream

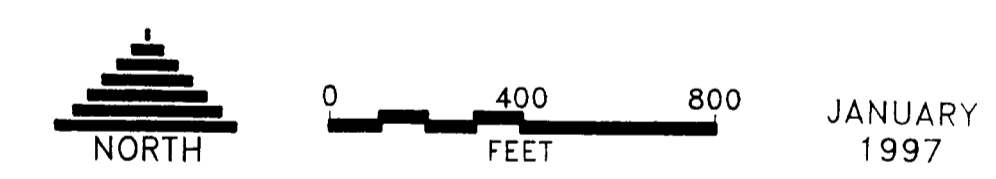
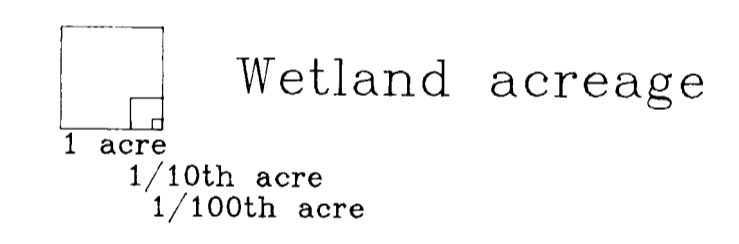

WETLAND INFORMATION IS SUBJECT TO CHANGE

This map is for planning purposes only. It has not been finalized and adopted by the City of Sandy or approved by the wetland regulatory agencies. You are advised to contact the Oregon Division of State Lands or the U.S. Army Corps of Engineers with any regulatory questions. Mapped wetland boundaries were not flagged or surveyed, but are accurate to within 25 feet, and there may be unmapped wetlands subject to regulation. Some areas have been identified as potential wetlands and are located on the maps. In all cases, actual field conditions determine wetland boundaries.

## City of Sandy

39250 Pioneer Boulevard  
Sandy, Oregon 97055

SRI/SHAPIRO AGCO  
INCORPORATED

APPROVED WETLANDS INVENTORY  
Oregon Division of State Lands  
Meets Local Wetlands Inventory Requirements  
Date 2-18-97 Approved by J. Moran

T 2S R 4E Section 11

# CITY OF SANDY LOCAL WETLAND INVENTORY

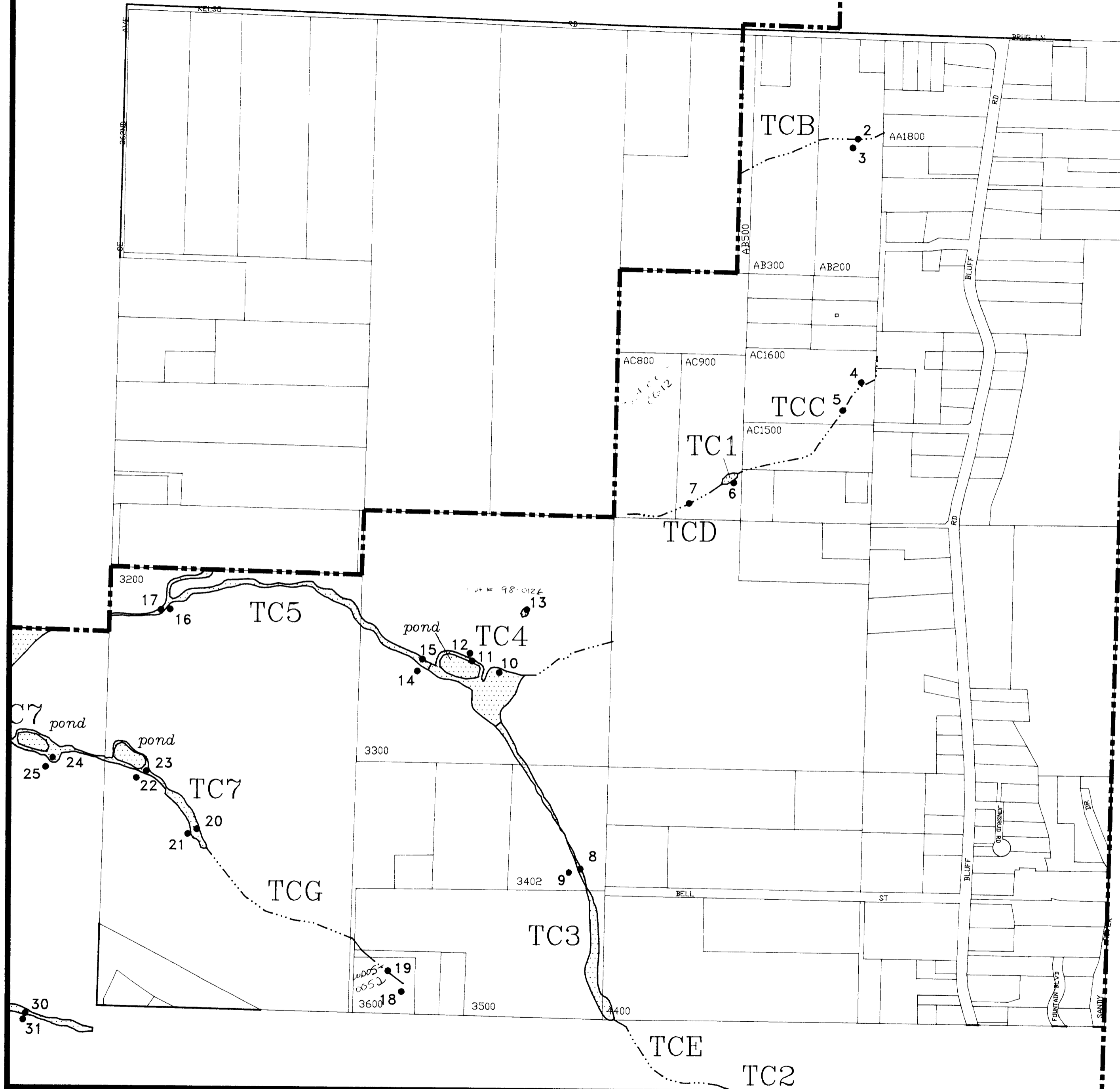

- <sup>8</sup> Sample site
- TC4 Wetland designator
- Urban Growth Boundary
- Potentially jurisdictional wetland
- Intermittent Stream

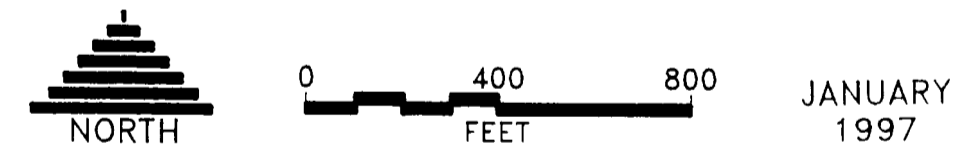
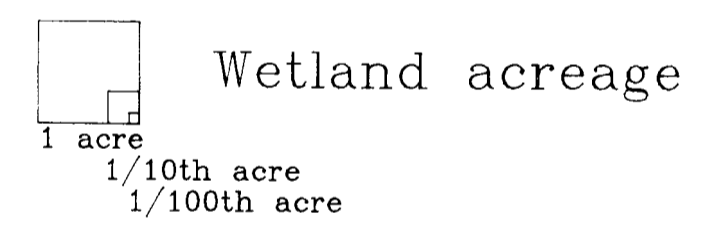

WETLAND INFORMATION IS SUBJECT TO CHANGE

This map is for planning purposes only. It has not been finalized and adopted by the City of Sandy or approved by the wetland regulatory agencies. You are advised to contact the Oregon Division of State Lands or the U.S. Army Corps of Engineers with any regulatory questions. Mapped wetland boundaries were not flagged or surveyed, but are accurate to within 25 feet, and there may be unmapped wetlands subject to regulation. Some areas have been identified as potential wetlands and are located on the maps. In all cases, actual field conditions determine wetland boundaries.

**City of Sandy**  
**39250 Pioneer Boulevard**  
**Sandy, Oregon 97055**

SRI/SHAPIRO/AGCO  
INCORPORATED

APPROVED WETLANDS INVENTORY  
 Oregon Division of State Lands  
 Meets Local Wetlands Inventory standards  
 Date 2-19-97 Approved by J. Malen

# CITY OF SANDY LOCAL WETLAND INVENTORY

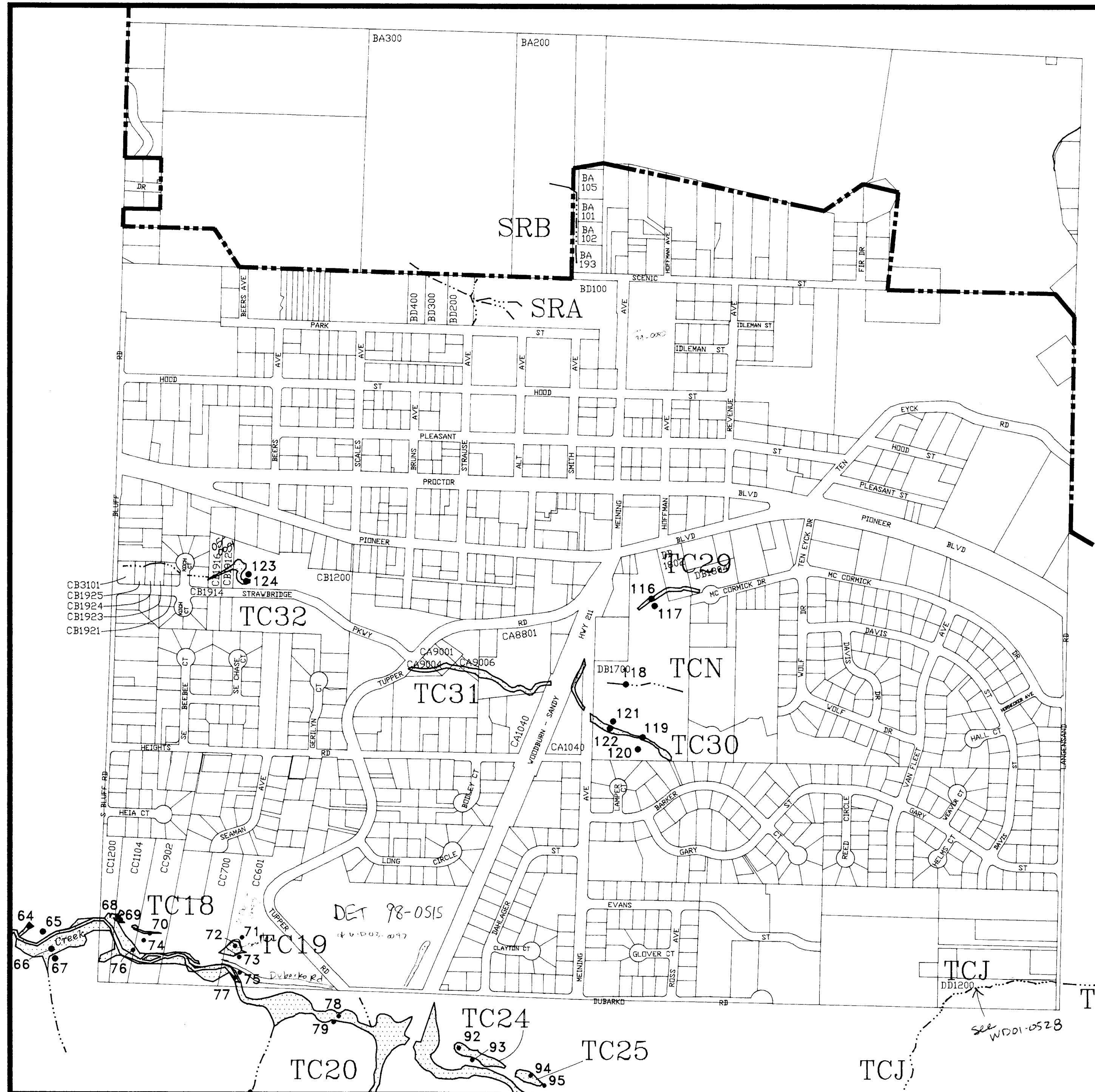

- 8 Sample site
- TC4 Wetland designator
- Urban Growth Boundary
- ☐ Potentially jurisdictional wetland
- Intermittent Stream
- ☐ Wetland acreage  
1 acre  
1/10th acre  
1/100th acre

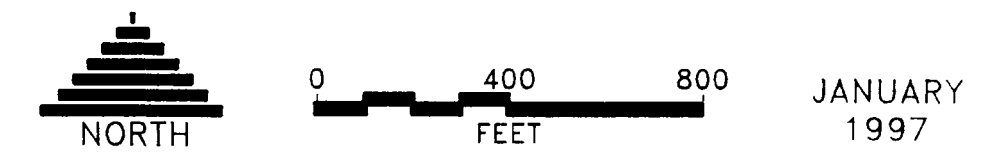

WETLAND INFORMATION IS SUBJECT TO CHANGE

This map is for planning purposes only. It has not been finalized and adopted by the City of Sandy or approved by the wetland regulatory agencies. You are advised to contact the Oregon Division of State Lands or the U.S. Army Corps of Engineers with any regulatory questions. Mapped wetland boundaries were not flagged or surveyed, but are accurate to within 25 feet, and there may be unmapped wetlands subject to regulation. Some areas have been identified as potential wetlands and are located on the maps. In all cases, actual field conditions determine wetland boundaries.

**City of Sandy**  
39250 Pioneer Boulevard  
Sandy, Oregon 97055

SRI/SHAPIRO/AGCO  
INCORPORATED

T 2S R 4E Section 14

# CITY OF SANDY LOCAL WETLAND INVENTORY

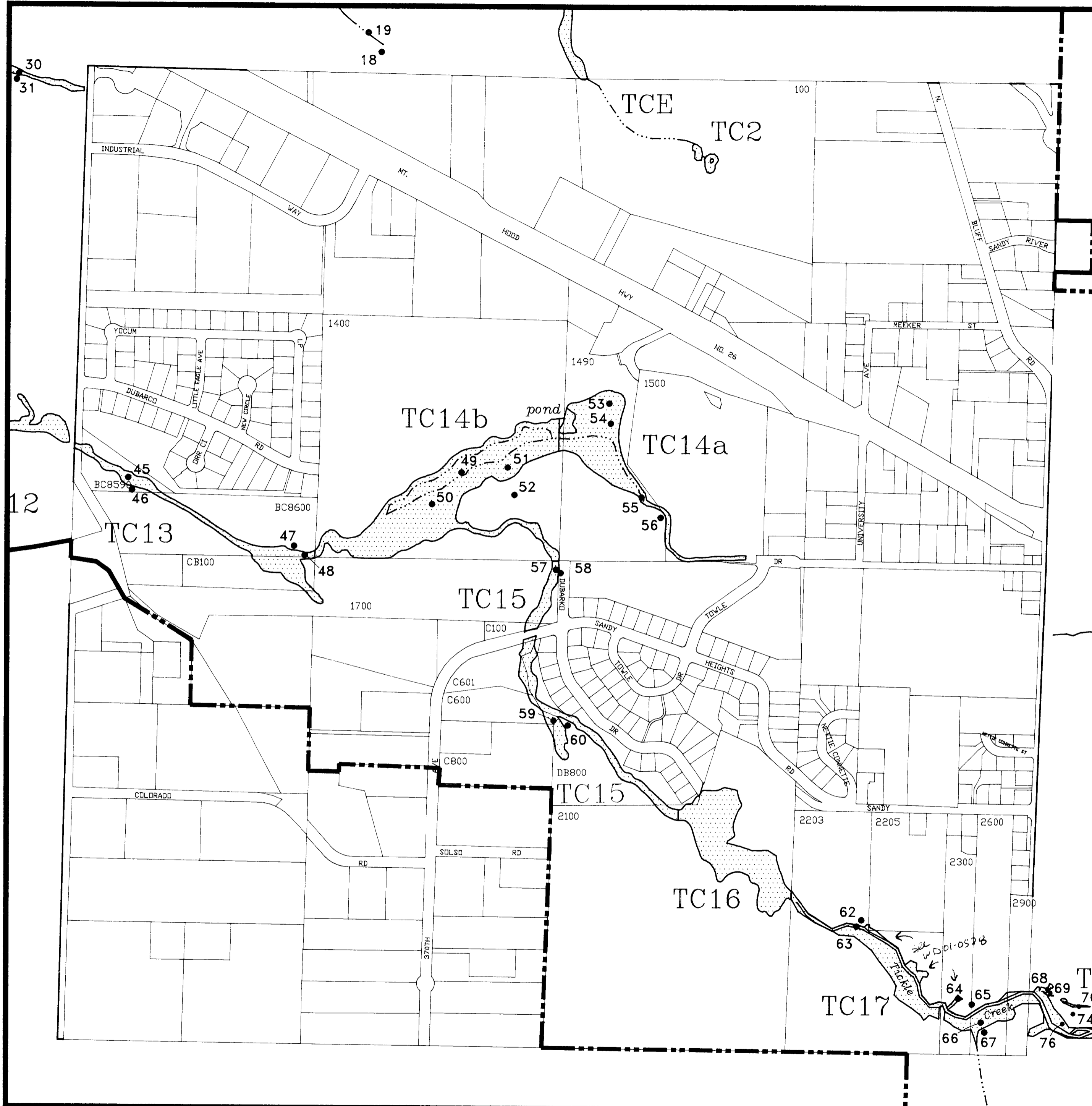

- 8 Sample site
- TC4 Wetland designator
- Urban Growth Boundary
- Potentially jurisdictional wetland
- - - - - Intermittent Stream

Wetland acreage

1 acre  
1/10th acre  
1/100th acre

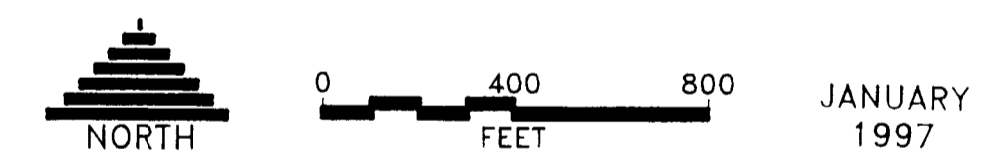

JANUARY 1997

WETLAND INFORMATION IS SUBJECT TO CHANGE

This map is for planning purposes only. It has not been finalized and adopted by the City of Sandy or approved by the wetland regulatory agencies. You are advised to contact the Oregon Division of State Lands or the U.S. Army Corps of Engineers with any regulatory questions. Mapped wetland boundaries were not flagged or surveyed, but are accurate to within 25 feet, and there may be unmapped wetlands subject to regulation. Some areas have been identified as potential wetlands and are located on the maps. In all cases, actual field conditions determine wetland boundaries.

## City of Sandy

39250 Pioneer Boulevard  
Sandy, Oregon 97055

SRI/SHAPIRO/AGCO  
INCORPORATED

APPROVED WETLAND INVENTORY  
Oregon Division of State Lands  
Meets Local Wetlands Inventory standards  
Date 2-18-17 Approved by J. Maden

T 2S R 4E Section 15

# CITY OF SANDY LOCAL WETLAND INVENTORY

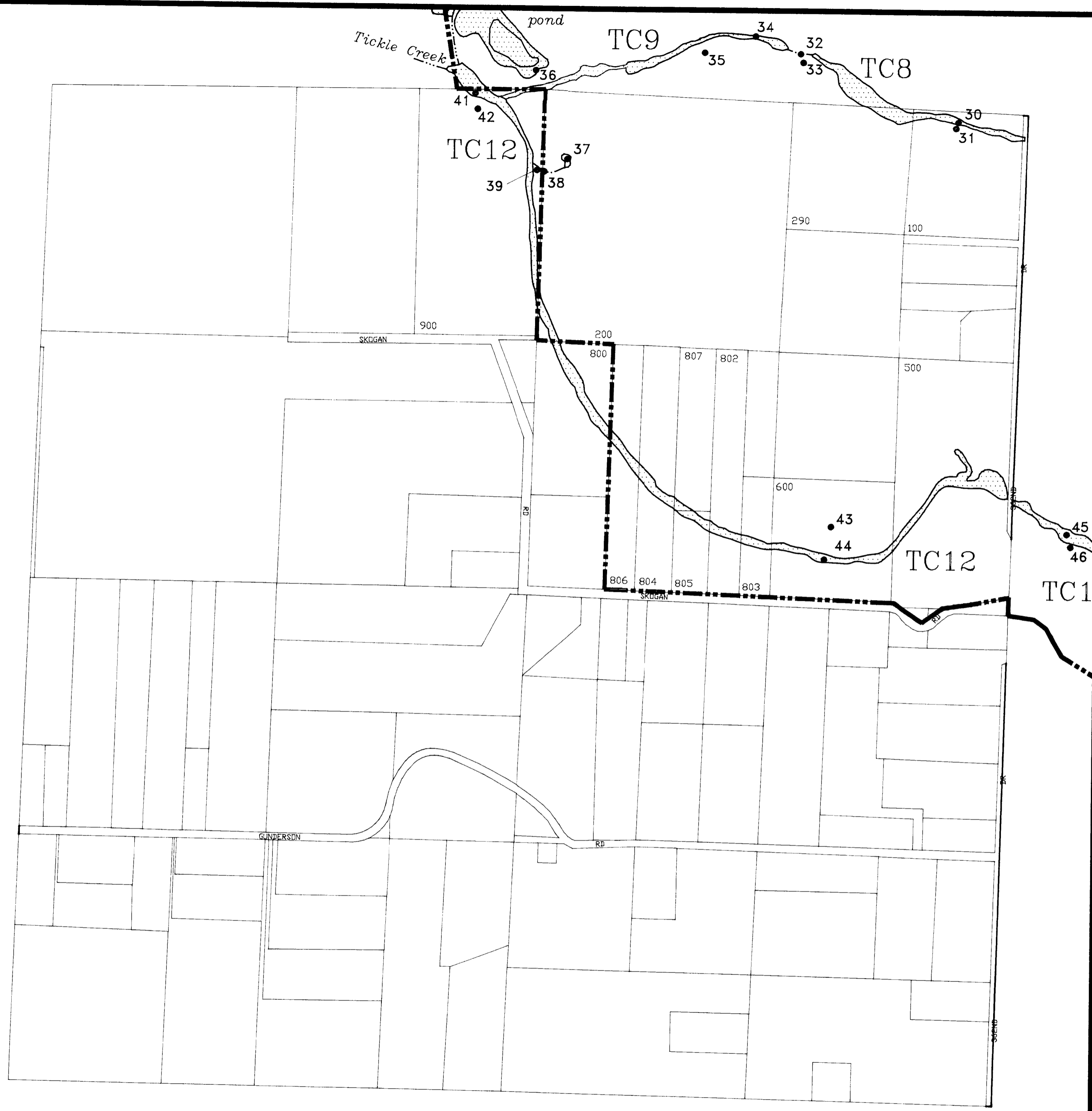

- 8 Sample site
- TC4 Wetland designator
- Urban Growth Boundary
- Potentially jurisdictional wetland
- ..... Intermittent stream

Wetland acreage

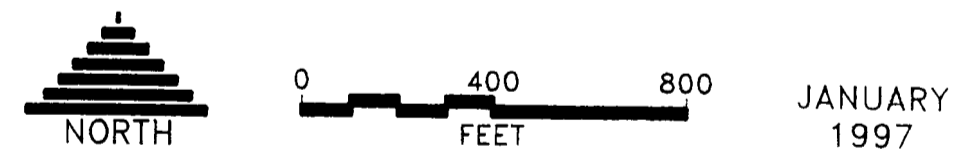

JANUARY 1997

### WETLAND INFORMATION IS SUBJECT TO CHANGE

This map is for planning purposes only. It has not been finalized and adopted by the City of Sandy or approved by the wetland regulatory agencies. You are advised to contact the Oregon Division of State Lands or the U.S. Army Corps of Engineers with any regulatory questions. Mapped wetland boundaries were not flagged or surveyed, but are accurate to within 25 feet, and there may be unmapped wetlands subject to regulation. Some areas have been identified as potential wetlands and are located on the maps. In all cases, actual field conditions determine wetland boundaries.

## City of Sandy

39250 Pioneer Boulevard  
Sandy, Oregon 97055



APPROVED WETLANDS INVENTORY  
Oregon Division of State Lands  
Meets Local Wetlands Inventory Act criteria  
Date 2-18-97 Approved by J. Madson

T 2S R 5E Section 18

# CITY OF SANDY LOCAL WETLAND INVENTORY

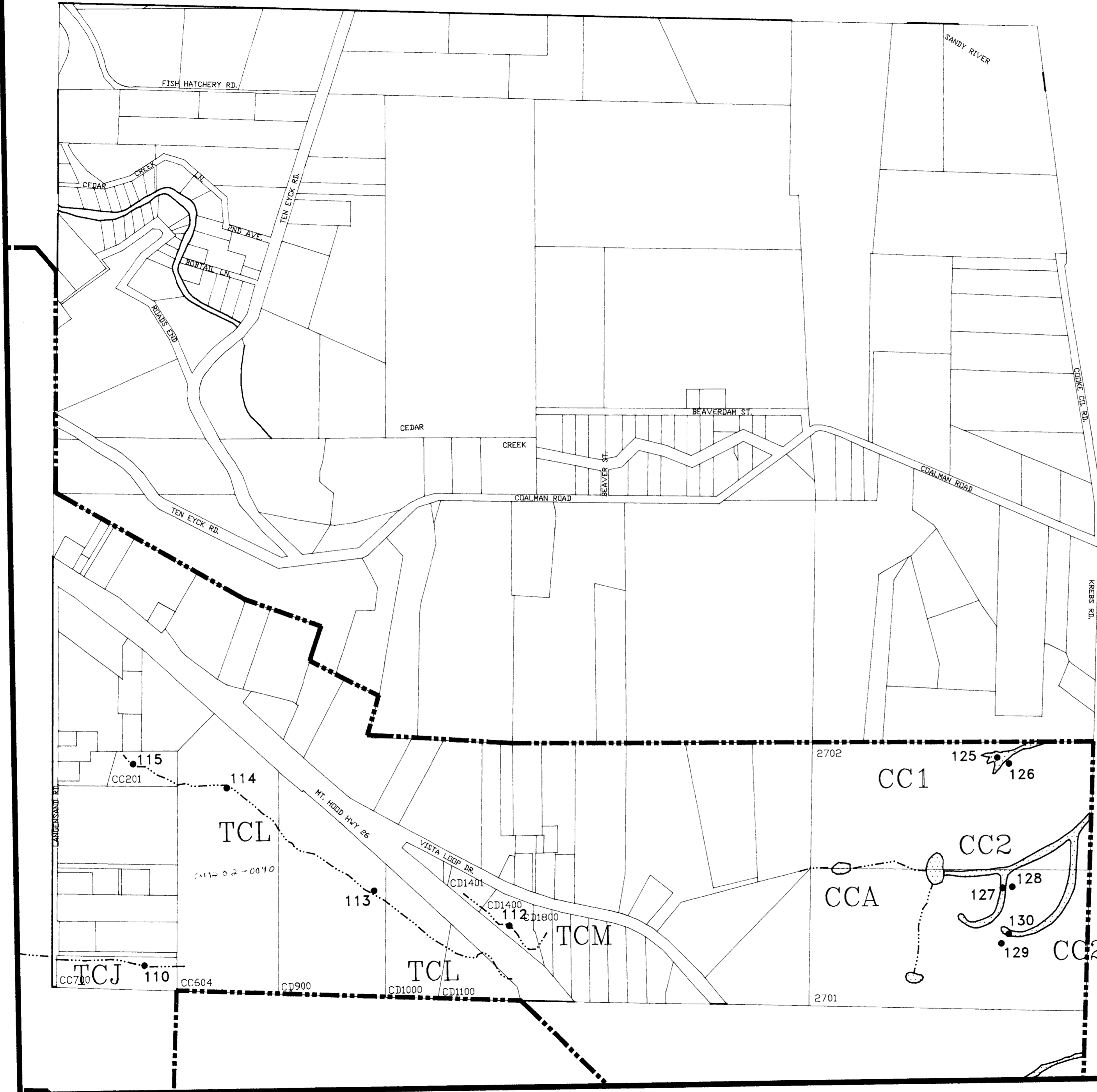

- <sup>8</sup> Sample site
- TC4 Wetland designator
- Urban Growth Boundary
- Potentially jurisdictional wetland
- Intermittent stream

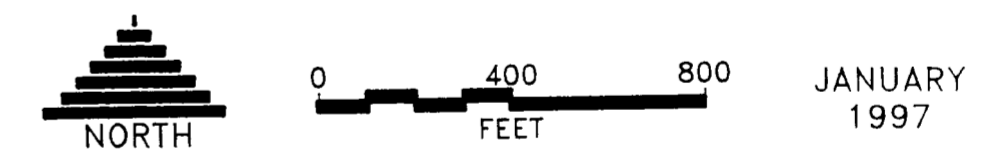
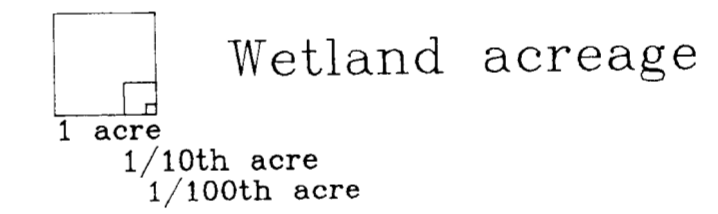

### WETLAND INFORMATION IS SUBJECT TO CHANGE

This map is for planning purposes only. It has not been finalized and adopted by the City of Sandy or approved by the wetland regulatory agencies. You are advised to contact the Oregon Division of State Lands or the U.S. Army Corps of Engineers with any regulatory questions. Mapped wetland boundaries were not flagged or surveyed, but are accurate to within 25 feet, and there may be unmapped wetlands subject to regulation. Some areas have been identified as potential wetlands and are located on the maps. In all cases, actual field conditions determine wetland boundaries.

## City of Sandy

39250 Pioneer Boulevard  
Sandy, Oregon 97055

SRI/SHAPIRO AGCO  
INCORPORATED

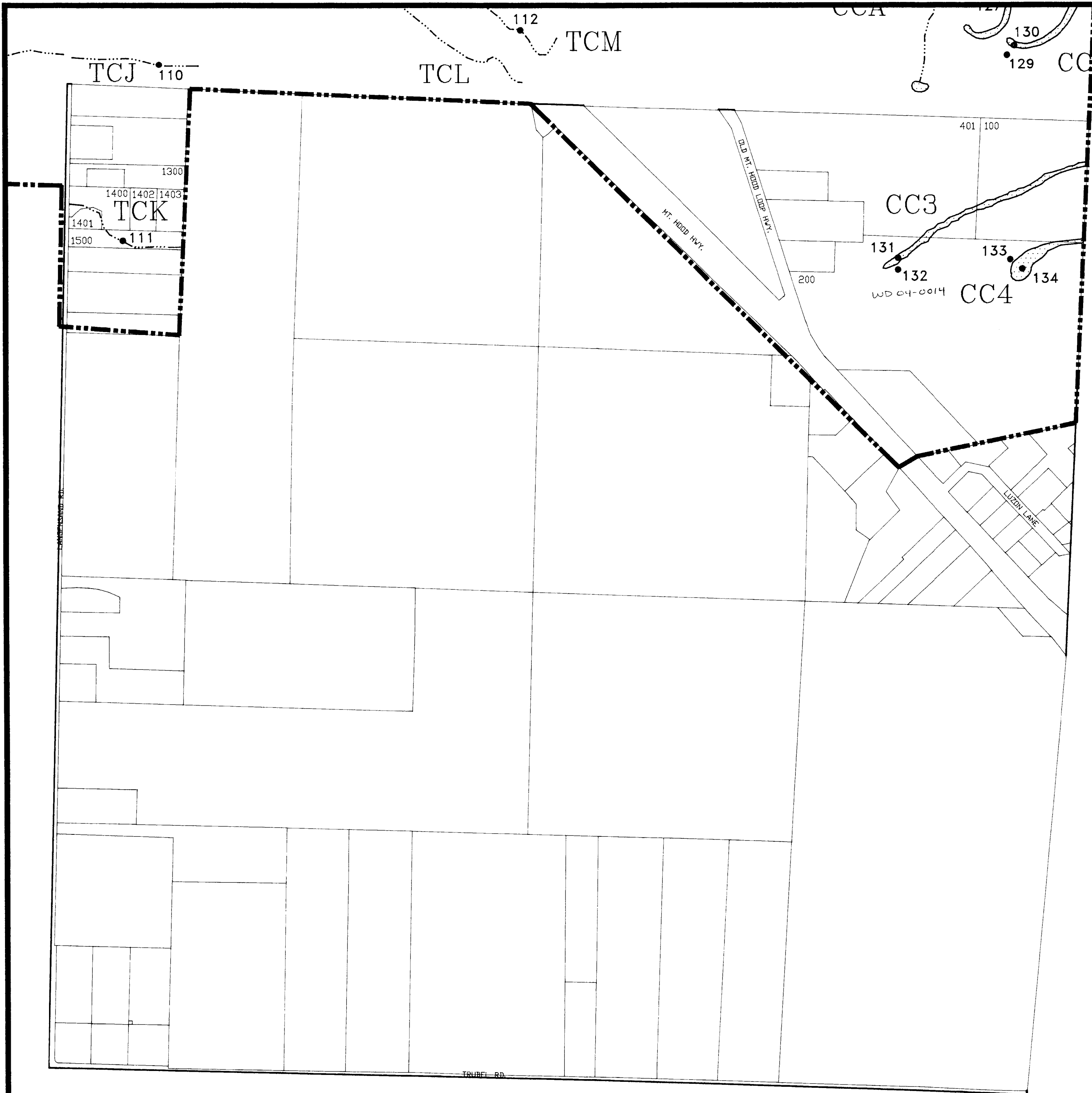

T 2S R 5E Section 19

# CITY OF SANDY LOCAL WETLAND INVENTORY

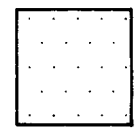
- 8 Sample site
- TC4 Wetland designator
- Urban Growth Boundary
-  Potentially jurisdictional wetland
- Intermittent stream

 Wetland acreage  
 1 acre  
 1/10th acre  
 1/100th acre

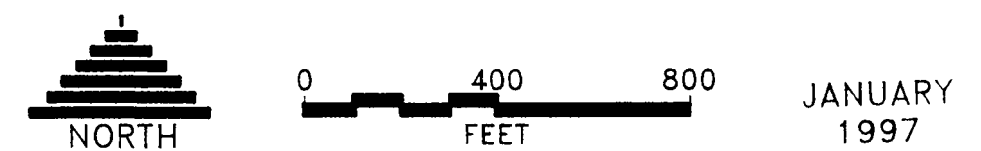

**WETLAND INFORMATION IS SUBJECT TO CHANGE**

This map is for planning purposes only. It has not been finalized and adopted by the City of Sandy or approved by the wetland regulatory agencies. You are advised to contact the Oregon Division of State Lands or the U.S. Army Corps of Engineers with any regulatory questions. Mapped wetland boundaries were not flagged or surveyed, but are accurate to within 25 feet, and there may be unmapped wetlands subject to regulation. Some areas have been identified as potential wetlands and are located on the maps. In all cases, actual field conditions determine wetland boundaries.

*City of Sandy*

**39250 Pioneer Boulevard  
Sandy, Oregon 97055**

 **SRI/SHAPIRO AGCO**  
INCORPORATED

City of Sandy Wetlands Inventory  
 Oregon Division of State Lands  
 Meets Local Wetlands Inventory standards  
 Date 2-18-97 Approved by J. Morlan

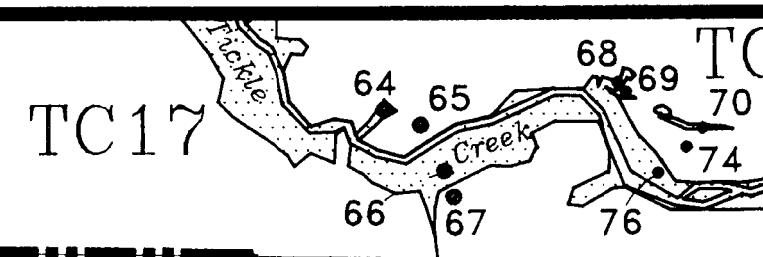

T 2S R 4E Section 23

# CITY OF SANDY LOCAL WETLAND INVENTORY



- 8 Sample site
- TC4 Wetland designator
- Urban Growth Boundary
- ▨ Potentially jurisdictional wetland
- ..... Intermittent stream

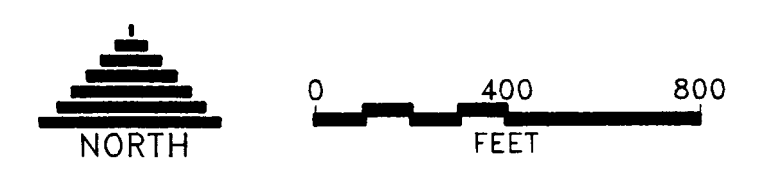
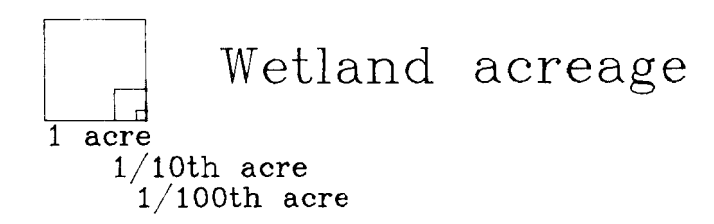

JANUARY 1997

**WETLAND INFORMATION IS SUBJECT TO CHANGE**

This map is for planning purposes only. It has not been finalized and adopted by the City of Sandy or approved by the wetland regulatory agencies. You are advised to contact the Oregon Division of State Lands or the U.S. Army Corps of Engineers with any regulatory questions. Mapped wetland boundaries were not flagged or surveyed, but are accurate to within 25 feet, and there may be unmapped wetlands subject to regulation. Some areas have been identified as potential wetlands and are located on the maps. In all cases, actual field conditions determine wetland boundaries.

## City of Sandy

39250 Pioneer Boulevard  
Sandy, Oregon 97055



AGCO WETLANDS INVENTORY  
Prepared for the City of Sandy  
Meets Local Wetlands Inventory requirements  
Date 2-19-97 Prepared by J. Maden

T 2S R 4E Section 24

# CITY OF SANDY LOCAL WETLAND INVENTORY

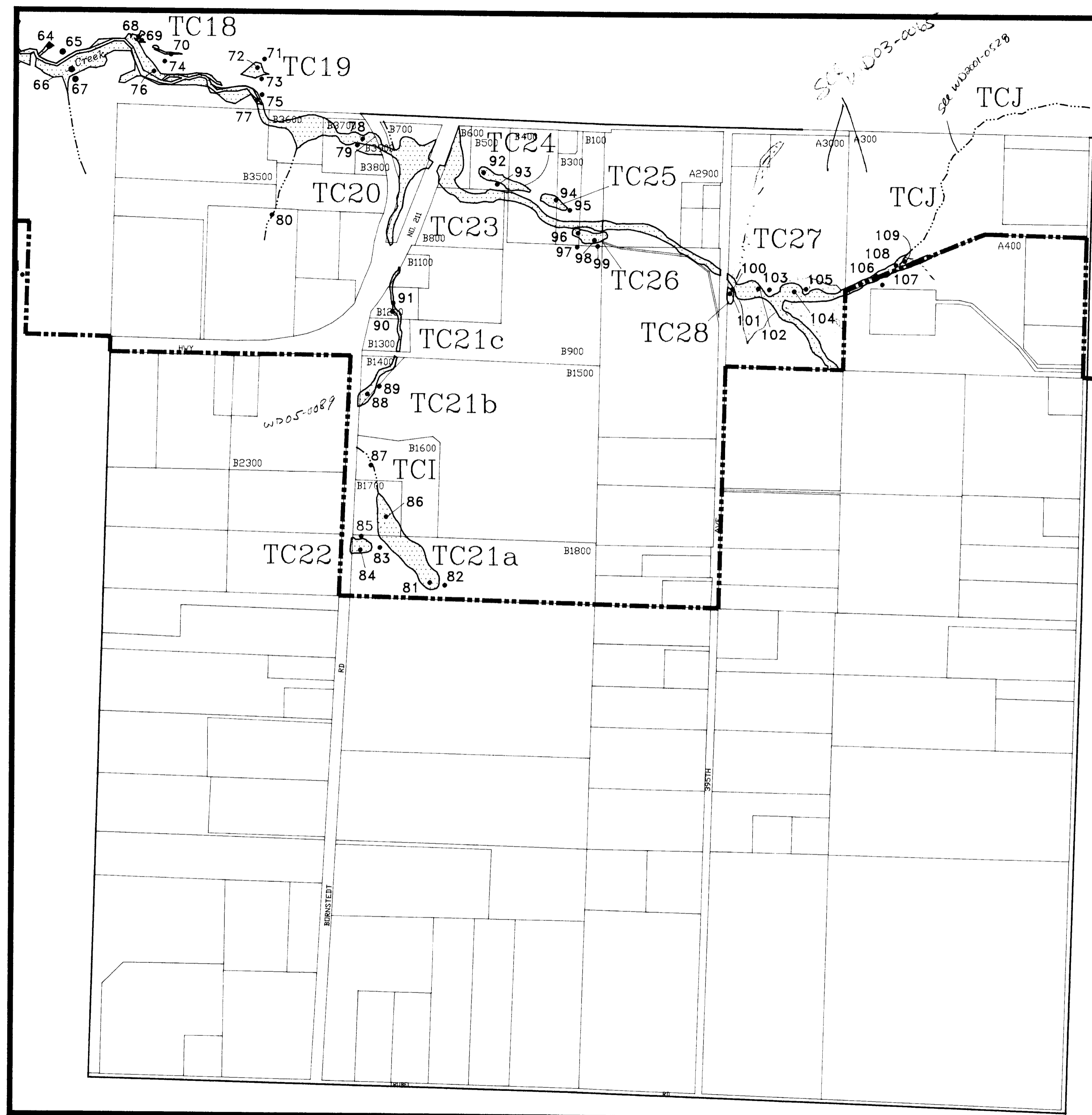

- Sample site
- Wetland designator
- Urban Growth Boundary
- Potentially jurisdictional wetland
- Intermittent stream
- Wetland acreage  
 1 acre  
 1/10th acre  
 1/100th acre

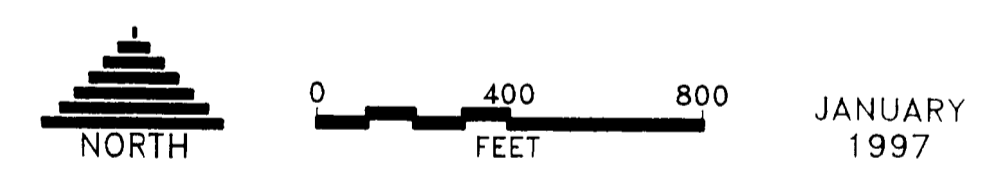

WETLAND INFORMATION IS SUBJECT TO CHANGE

This map is for planning purposes only. It has not been finalized and adopted by the City of Sandy or approved by the wetland regulatory agencies. You are advised to contact the Oregon Division of State Lands or the U.S. Army Corps of Engineers with any regulatory questions. Mapped wetland boundaries were not flagged or surveyed, but are accurate to within 25 feet, and there may be unmapped wetlands subject to regulation. Some areas have been identified as potential wetlands and are located on the maps. In all cases, actual field conditions determine wetland boundaries.

## City of Sandy

39250 Pioneer Boulevard  
Sandy, Oregon 97055

SRI/SHAPIRO AGCO  
INCORPORATED

WETLANDS INVENTORY  
 Local Wetlands Inventory  
 Date 2/19/97 Approved by J. Morlan