

- Project Boundary
- Watershed Boundary
- Urban Growth Boundary
- City Limits
- Stream
- On Site Wetland Determination
- Off Site Wetland Determination
- Sample Point
- Wetland Code

58
 JCR-1
 Funding for this project was provided by a grant from the Oregon Division of State Lands, wetlands planning assistance grant program. This grant program is supported by a grant from the U.S. Environmental Protection Agency under authority of the Clean Water Act.



NOT TO SCALE

SCAPPOOSE

This map is for planning purposes only. It has not been finalized and adopted by the City of Scappoose or approved by the wetland regulatory agencies. You are advised to contact the Oregon Division of State Lands or the U.S. Army Corps of Engineers with any regulatory questions. Mapped wetland boundaries are accurate to within 25 feet, however, there may be unmapped wetlands subject to regulation. In all cases, actual field conditions determine wetland boundaries.

APPROVED WETLANDS INVENTORY
 Oregon Division of State Lands
 Meets local wetland mapping standards
 Date: 11/98. Approved by: *[Signature]*

Reference Sheet
 Pacific Habitat Services, Inc.
 9450 SW Commerce Circle, Suite 180
 Wilsonville, Oregon 97070
 Phone: (503) 570-0800

Scappoose Local Wetlands Inventory

DATE: December, 1998
 BASE MAP INFO: Supplied by City of Scappoose
 : K.C.M. Engineering
 JOB NO.: 7-1427

Pacific Habitat Services, Inc.
9450 SW Commerce Circle, Suite 100
Wilsonville, Oregon 97070
Phone: (503) 370-0800



Scappoose Local Wetlands Inventory

DATE: December, 1998
BASE MAP INFO: Supplied by City of Scappoose
K.C.M. Engineering
JOB NO.: 7-1427

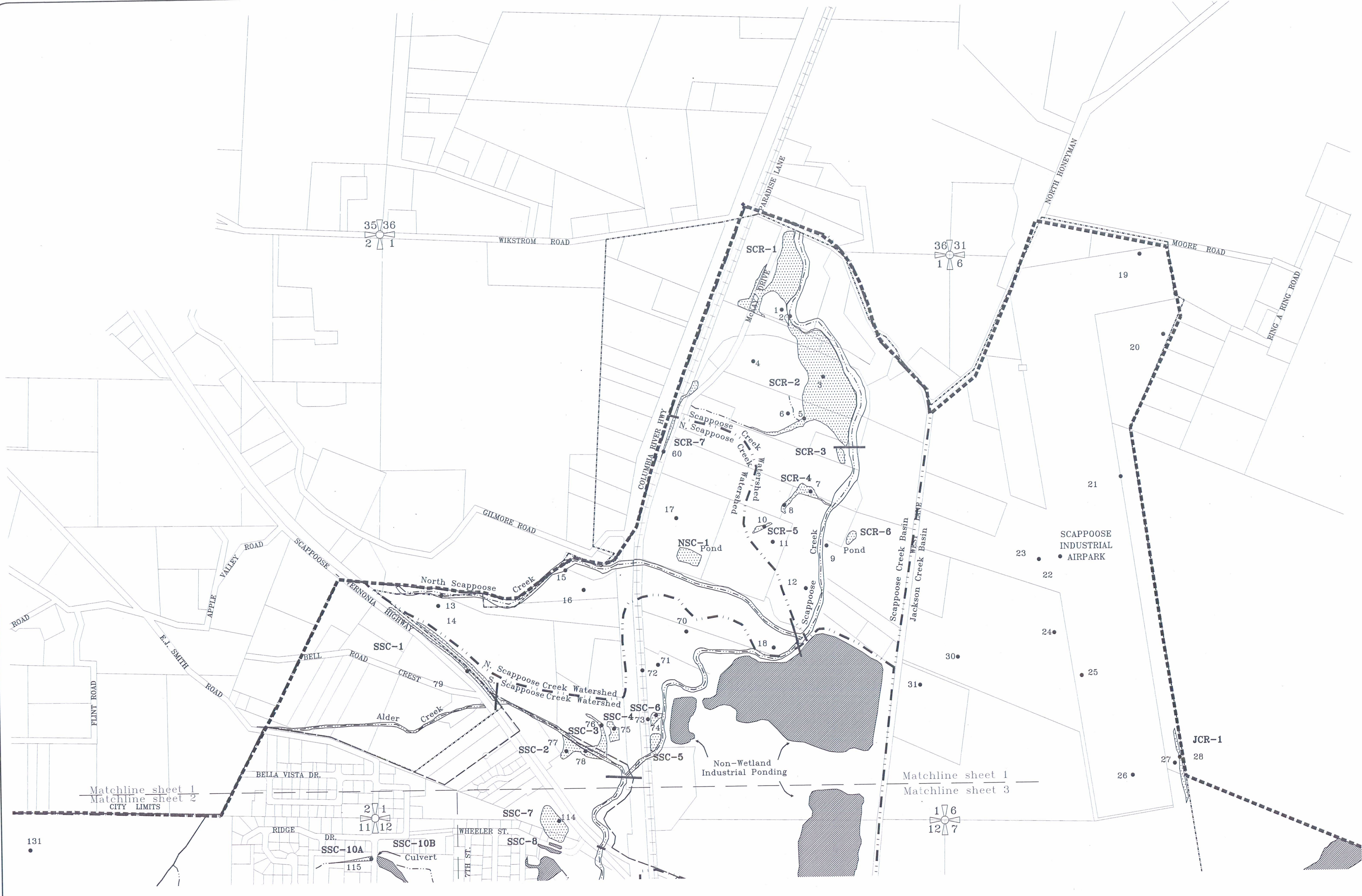

Project Boundary	-----	On Site Wetland Determination	[Stippled Pattern]
Watershed Boundary	- - - - -	Off Site Wetland Determination	[Hatched Pattern]
Urban Growth Boundary	Sample Point	• 58
City Limits	-----	Wetland Code	JCR-1
Stream	~~~~~		

Funding for this project was provided by a grant from the Oregon Division of State Lands, wetlands planning assistance grant program. This grant program is supported by a grant from the U.S. Environmental Protection Agency under authority of the Clean Water Act.

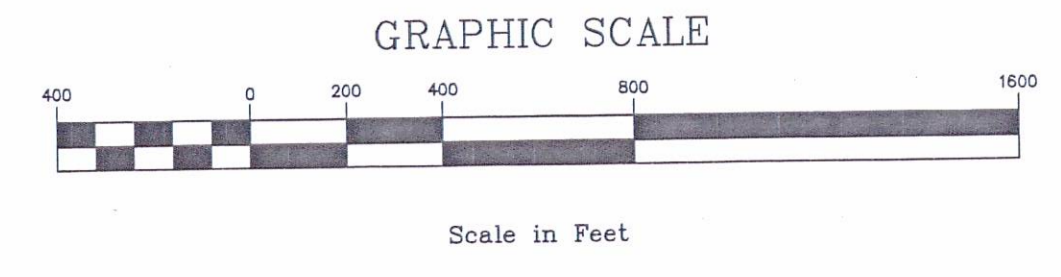
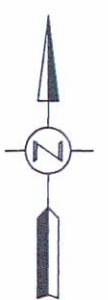

This map is for planning purposes only. It has not been finalized and adopted by the City of Scappoose or approved by the wetland regulatory agencies. You are advised to contact the Oregon Division of State Lands or the U.S. Army Corps of Engineers with any regulatory questions. Mapped wetland boundaries are accurate to within 25 feet, however, there may be unmapped wetlands subject to regulation. In all cases, actual field conditions determine wetland boundaries.

3/2
10/11

Matchline sheet 1
Matchline sheet 2
CITY LIMITS

2/1
11/12

10/11
15/14

Matchline sheet 2
Matchline sheet 4

Matchline sheet 3
Matchline sheet 4

- Project Boundary
- Watershed Boundary
- Urban Growth Boundary
- City Limits
- Stream
- On Site Wetland Determination
- Off Site Wetland Determination
- Sample Point
- Wetland Code

Funding for this project was provided by a grant from the Oregon Division of State Lands, wetlands planning assistance grant program. This grant program is supported by a grant from the U.S. Environmental Protection Agency under authority of the Clean Water Act.

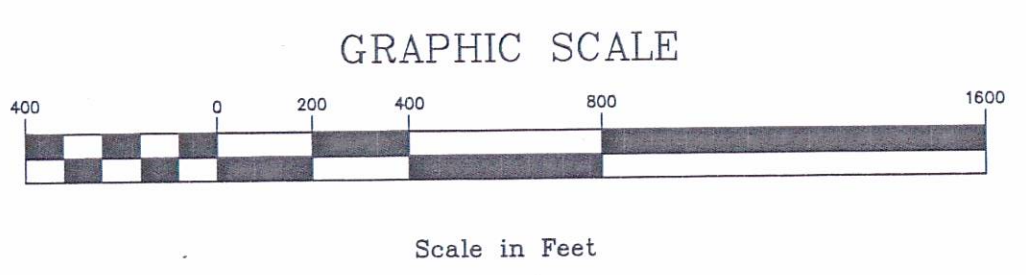
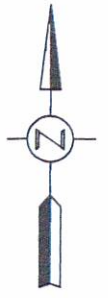

This map is for planning purposes only. It has not been finalized and adopted by the City of Scappoose or approved by the wetland regulatory agencies. You are advised to contact the Oregon Division of State Lands or the U.S. Army Corps of Engineers with any regulatory questions. Mapped wetland boundaries are accurate to within 25 feet, however, there may be unmapped wetlands subject to regulation. In all cases, actual field conditions determine wetland boundaries.

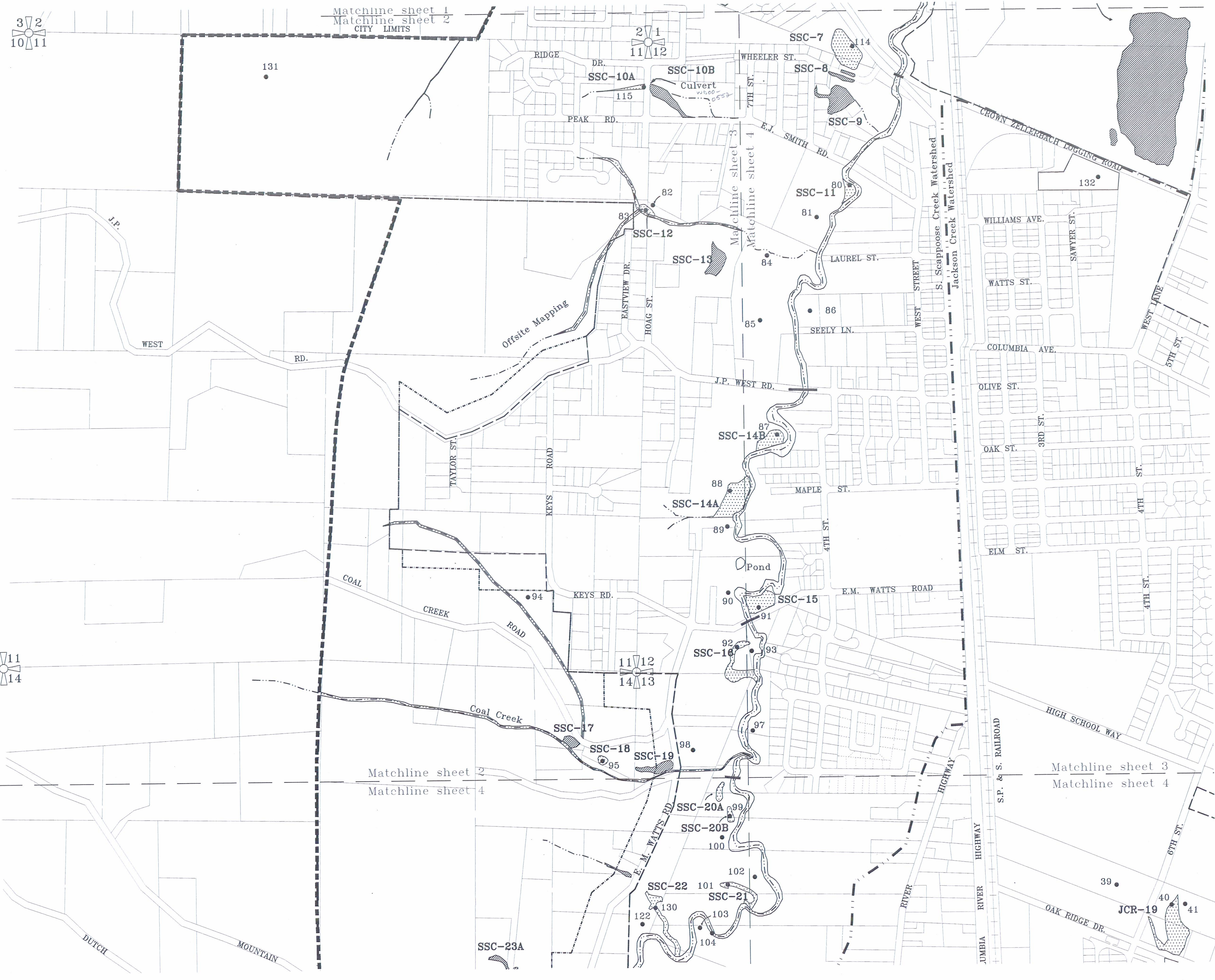

Pacific Habitat Services, Inc.
9450 SW Commerce Circle, Suite 180
Wilsonville, Oregon 97070
Phone: (503) 570-0800

Scappoose Local Wetlands Inventory

DATE: December, 1998
BASE MAP INFO: Supplied by City of Scappoose
K.C.M. Engineering

Sheet: 2
of: 4

7-1427

JOB NO.:

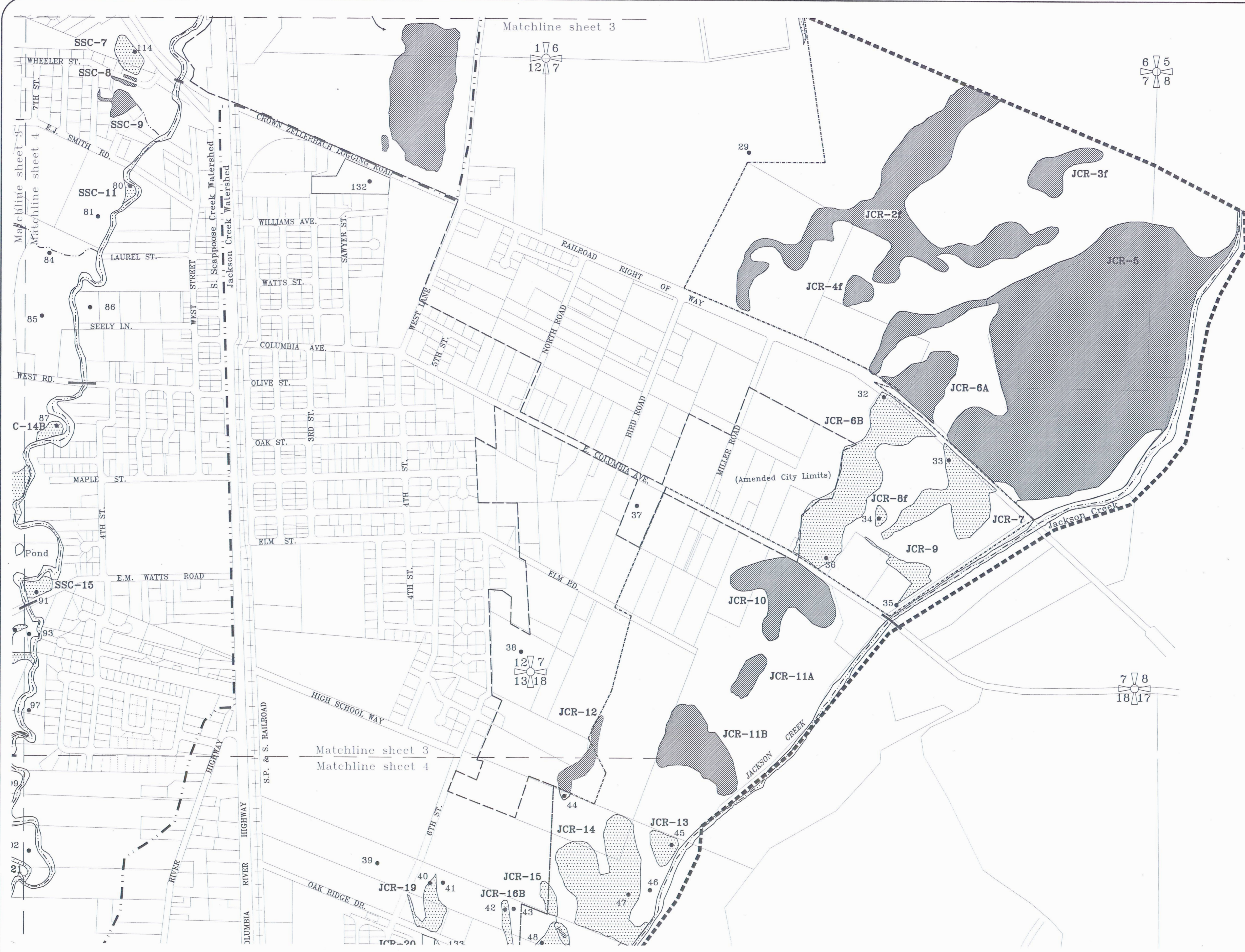

Project Boundary	On Site Wetland Determination	Sample Point
Watershed Boundary	Off Site Wetland Determination	Wetland Code
Urban Growth Boundary	City Limits	Stream

JCR-1
 58

Funding for this project was provided by a grant from the Oregon Division of State Lands, wetlands planning assistance grant program. This grant program is supported by a grant from the U.S. Environmental Protection Agency under authority of the Clean Water Act.

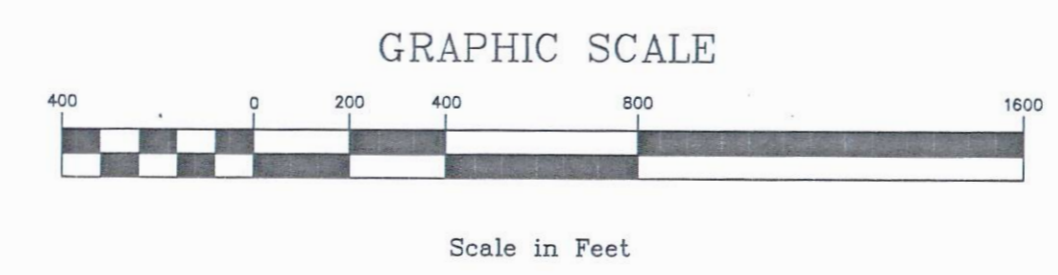

This map is for planning purposes only. It has not been finalized and adopted by the City of Scappoose or approved by the wetland regulatory agencies. You are advised to contact the Oregon Division of State Lands or the U.S. Army Corps of Engineers with any regulatory questions. Mapped wetland boundaries are accurate to within 25 feet, however, there may be unmapped wetlands subject to regulation. In all cases, actual field conditions determine wetland boundaries.



Scappoose Local Wetlands Inventory

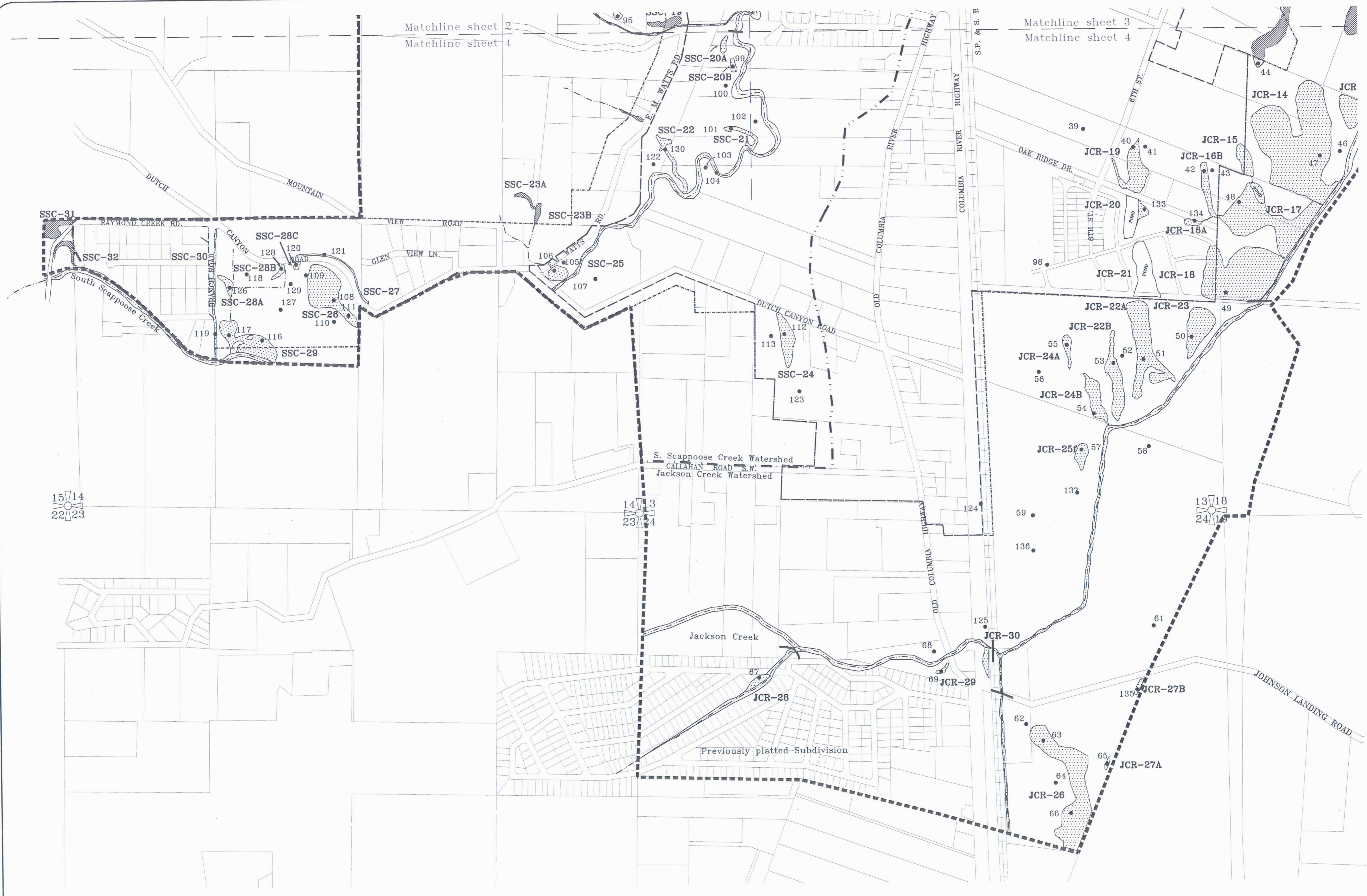

15/14
22/23

14/13
23/24

13/18
24/19

Project Boundary	-----	On Site Wetland Determination	[Stippled Area]
Watershed Boundary	- . - . - .	Off Site Wetland Determination	[Hatched Area]
Urban Growth Boundary	-----	Sample Point	● 58
City Limits	-----	Wetland Code	JCR-1
Stream	~~~~~		

Funding for this project was provided by a grant from the Oregon Division of State Lands, wetlands planning assistance grant program. This grant program is supported by a grant from the U.S. Environmental Protection Agency under authority of the Clean Water Act.

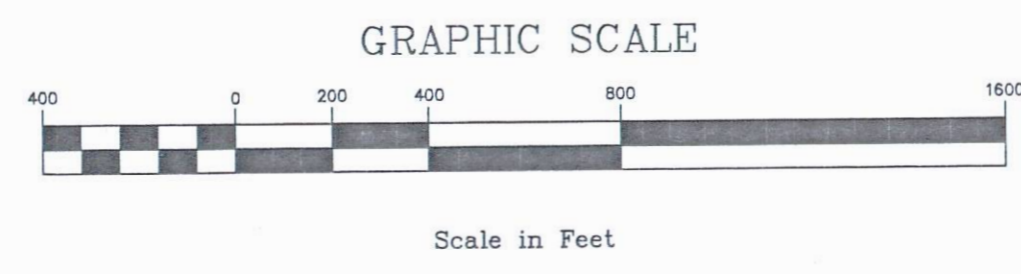

This map is for planning purposes only. It has not been finalized and adopted by the City of Scappoose or approved by the wetland regulatory agencies. You are advised to contact the Oregon Division of State Lands or the U.S. Army Corps of Engineers with any regulatory questions. Mapped wetland boundaries are accurate to within 25 feet, however, there may be unmapped wetlands subject to regulation. In all cases, actual field conditions determine wetland boundaries.

Pacific Habitat Services, Inc.
9450 SW Commerce Circle, Suite 180
Wilsonville, Oregon 97070
Phone: (503) 570-0800



Scappoose Local Wetlands Inventory

Sheet: 4

of: 4

DATE: December, 1998

BASE MAP INFO: Supplied by City of Scappoose

K.C.M. Engineering

JOB NO.: 7-1427