

**TOWN OF LAKEVIEW
LOCAL WETLANDS
INVENTORY
LAKEVIEW, OREGON**

Waiting for Final Approval

PREPARED FOR:

TOWN OF LAKEVIEW

JULY 2003

PREPARED BY:

Anderson Engineering
PO Box 28
Lakeview, Oregon 97306

and















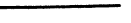
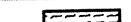
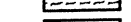

PREPARED BY:

Adolfson Associates, Inc.
333 SW Fifth Avenue, Ste 600
Portland, Oregon 97204
503.226.8018



TOWN OF LAKEVIEW LOCAL WETLAND INVENTORY

T 39S R 20E SECTION 4

-  LAKEVIEW TOWN LIMITS
-  URBAN GROWTH BOUNDARY
-  WATERWAY
-  TAX LOT BOUNDARY
-  EXISTING ROAD R.O.W.
-  OPEN WATER
-  WETLAND AREA
-  MOSAIC WETLAND AREA
-  WETLAND LABEL
-  FIELD VERIFIED
-  YES
-  NO
-  POTENTIAL WETLAND
-  DATA PLOT
-  DATA PLOT LABEL
-  STREAM OR DITCH
-  DELINEATION FILE NO.
-  EXCAVATED

INFORMATION SHOWN OF THIS MAP IS FOR PLANNING PURPOSES ONLY AND WETLAND INFORMATION IS SUBJECT TO CHANGE. THERE MAY BE UNMAPPED WETLANDS SUBJECT TO REGULATION AND ALL WETLAND BOUNDARY MAPPING IS APPROXIMATE. IN ALL CASES, ACTUAL FIELD CONDITIONS DETERMINE WETLAND BOUNDARIES. YOU ARE ADVISED TO CONTACT THE OREGON DIVISION OF STATE LANDS AND THE U.S. ARMY CORPS OF ENGINEERS WITH ANY REGULATORY QUESTIONS.

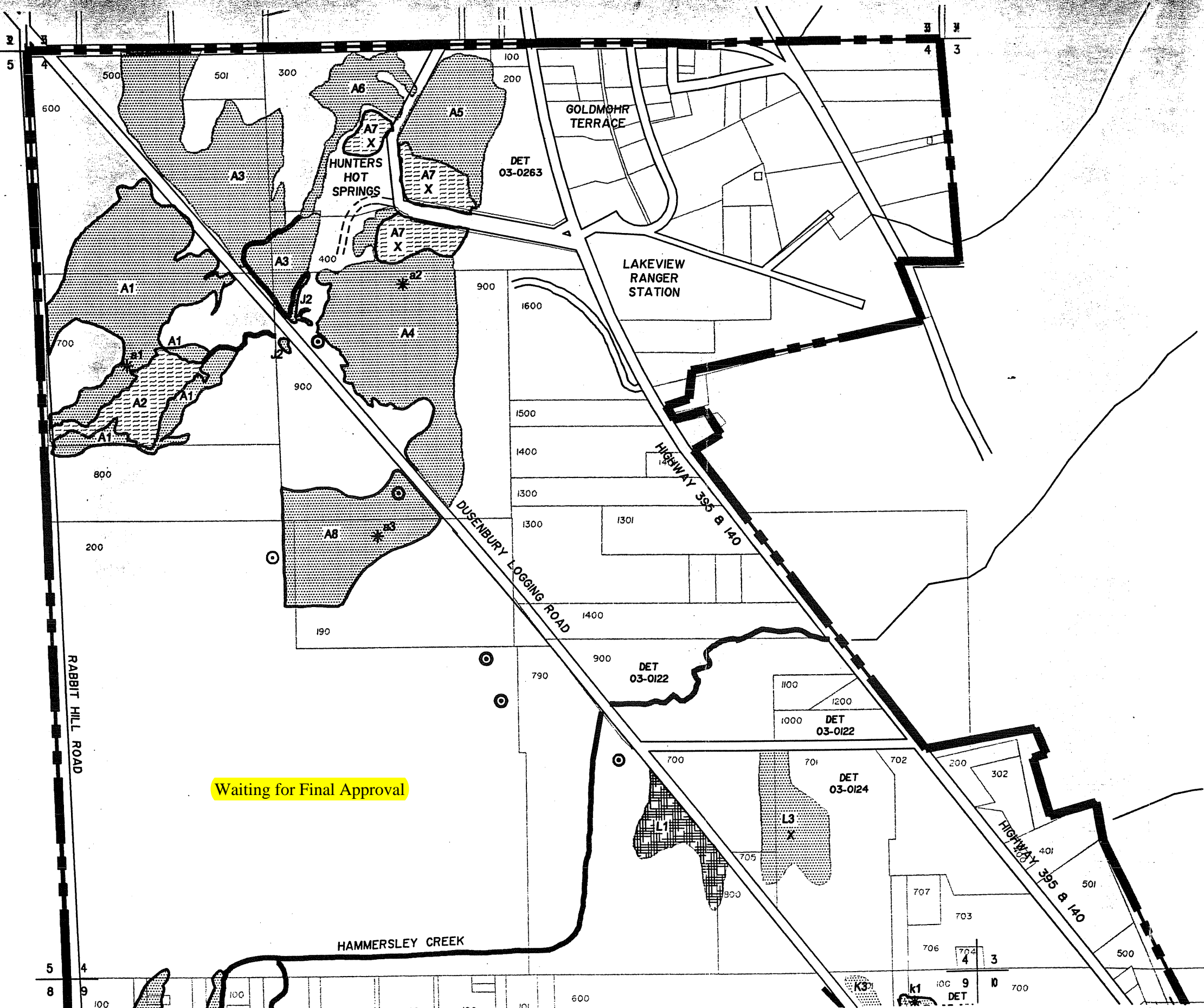
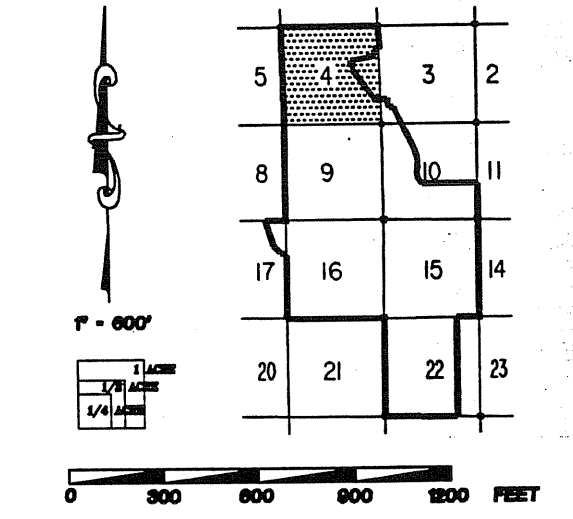

Waiting for Final Approval

OCTOBER 31, 2002
REVISED JUNE 2003
REVISED JULY 2003

MAP PREPARED BY:



ANDERSON ENGINEERING AND SURVEYING, INC.
17681 HIGHWAY 395
LAKEVIEW, OR 97630
(541) 947-4407
FAX (541) 947-2321

JOB NO.: 2002-04 DRAWING: 2002-04 SHEET 2 OF 7

MAPS BASED ON LAKE COUNTY ASSESSOR MAPS

TOWN OF LAKEVIEW LOCAL WETLAND INVENTORY

T 39S R 20E SECTION 9

- ■ ■ ■ LAKEVIEW TOWN LIMITS
- ■ ■ ■ URBAN GROWTH BOUNDARY
- WATERWAY
- TAX LOT BOUNDARY
- EXISTING ROAD R.O.W.
- ▨ OPEN WATER
- ▨ WETLAND AREA
- ▨ MOSAIC WETLAND AREA
- A1 WETLAND LABEL
- FIELD VERIFIED
- YES
- NO
- ⊙ POTENTIAL WETLAND
- * DATA PLOT
- a1 DATA PLOT LABEL
- STREAM OR DITCH
- DET 03-0263 DELINEATION FILE NO.
- X EXCAVATED

INFORMATION SHOWN OF THIS MAP IS FOR PLANNING PURPOSES ONLY AND WETLAND INFORMATION IS SUBJECT TO CHANGE. THERE MAY BE UNMAPPED WETLANDS SUBJECT TO REGULATION AND ALL WETLAND BOUNDARY MAPPING IS APPROXIMATE. IN ALL CASES, ACTUAL FIELD CONDITIONS DETERMINE WETLAND BOUNDARIES. YOU ARE ADVISED TO CONTACT THE OREGON DIVISION OF STATE LANDS AND THE U.S. ARMY CORPS OF ENGINEERS WITH ANY REGULATORY QUESTIONS.

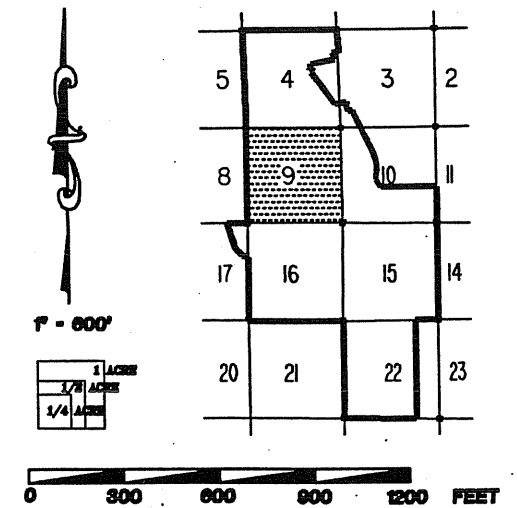

MAP PREPARED BY:

OCTOBER 31, 2002
REVISED JUNE 2003
REVISED JULY 2003



ANDERSON ENGINEERING AND SURVEYING, INC.
17681 HIGHWAY 395
LAKEVIEW, OR 97830
(541) 947-4407
FAX (541) 947-2221

JOB NO.: 2002-04

DRAWING: 2002-04

SHEET 3 OF 7

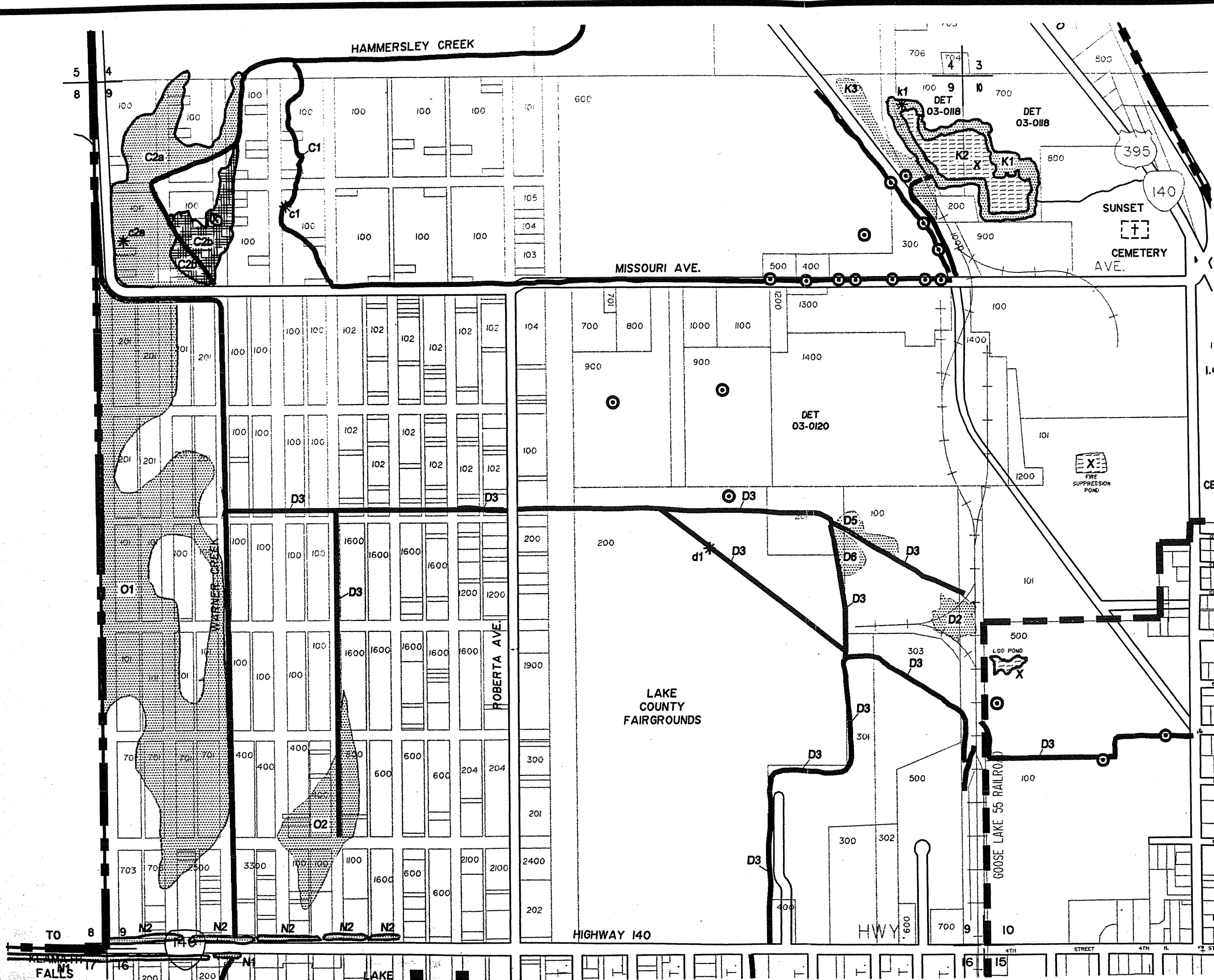

TOWN OF LAKEVIEW LOCAL WETLAND INVENTORY

T 39S R 20E SECTION 10

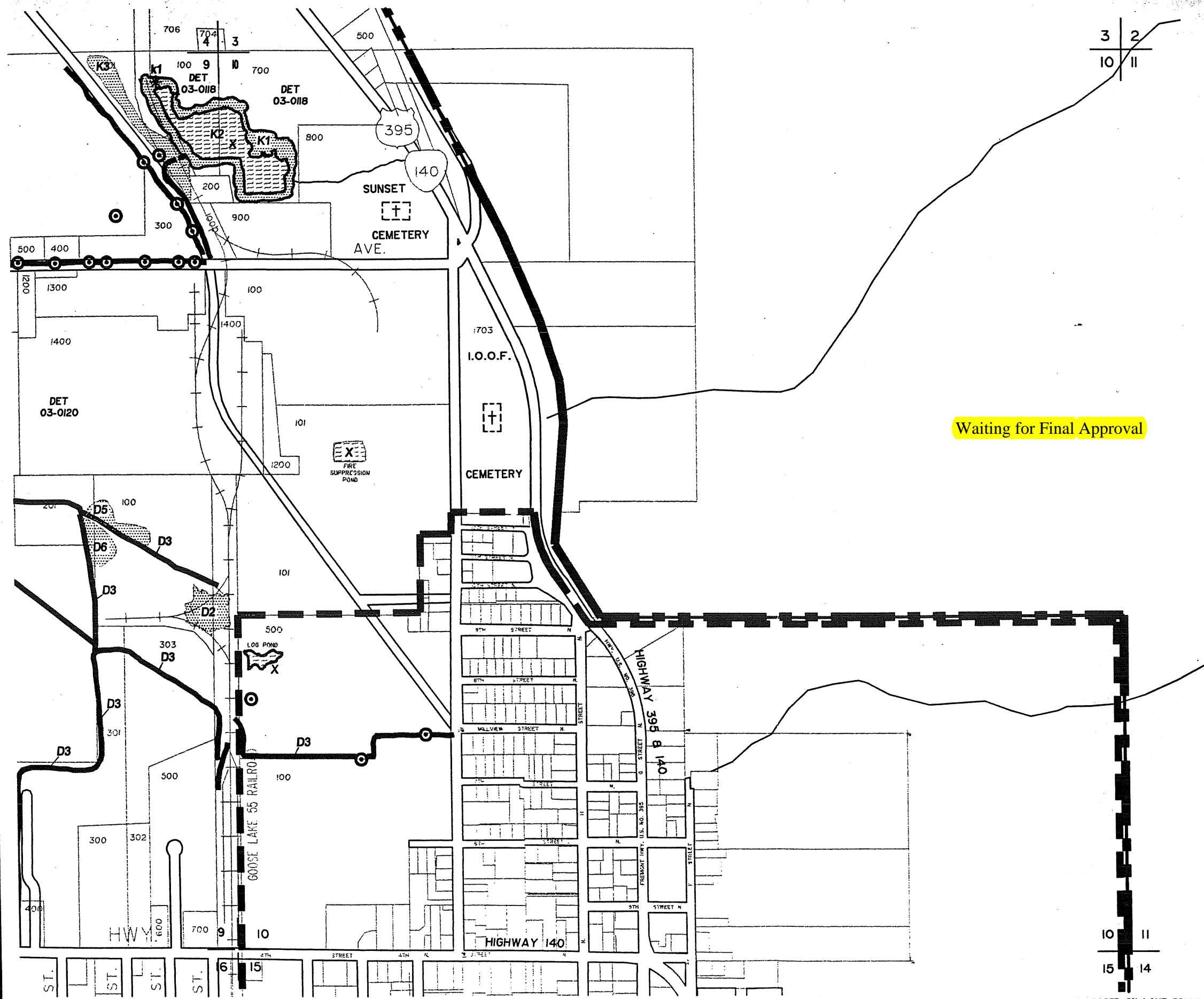

- ▬▬▬▬ LAKEVIEW TOWN LIMITS
- ▬▬▬▬ URBAN GROWTH BOUNDARY
- ▬▬▬▬ WATERWAY
- ▬▬▬▬ TAX LOT BOUNDARY
- ▬▬▬▬ EXISTING ROAD R.O.W.
- ▬▬▬▬ OPEN WATER
- ▬▬▬▬ WETLAND AREA
- ▬▬▬▬ MOSAIC WETLAND AREA
- A1 WETLAND LABEL
- FIELD VERIFIED
- YES
- NO
- ⊙ POTENTIAL WETLAND
- * DATA PLOT
- a1 DATA PLOT LABEL
- ▬▬▬▬ STREAM OR DITCH
- DET 03-0263 DELINEATION FILE NO.
- X EXCAVATED

INFORMATION SHOWN OF THIS MAP IS FOR PLANNING PURPOSES ONLY AND WETLAND INFORMATION IS SUBJECT TO CHANGE. THERE MAY BE UNMAPPED WETLANDS SUBJECT TO REGULATION AND ALL WETLAND BOUNDARY MAPPING IS APPROXIMATE. IN ALL CASES, ACTUAL FIELD CONDITIONS DETERMINE WETLAND BOUNDARIES. YOU ARE ADVISED TO CONTACT THE OREGON DIVISION OF STATE LANDS AND THE U.S. ARMY CORPS OF ENGINEERS WITH ANY REGULATORY QUESTIONS.

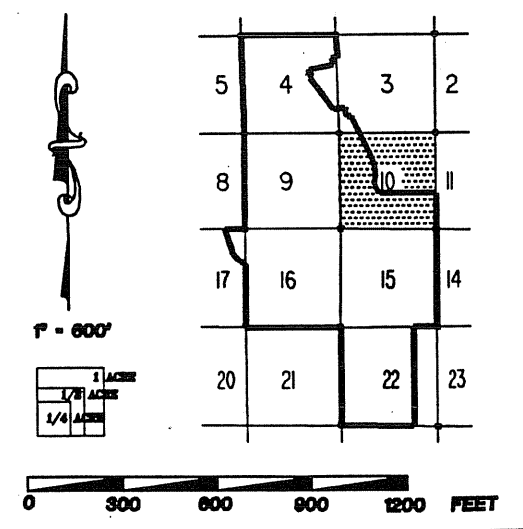

OCTOBER 31, 2002
REVISED JUNE 2003
REVISED JULY 2003

MAP PREPARED BY:













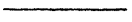

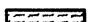
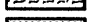

ANDERSON ENGINEERING AND SURVEYING, INC.
17681 HIGHWAY 395
LAKEVIEW, OR 97630
(541) 947-4407
FAX (541) 947-2321

MAPS BASED ON LAKE COUNTY ASSESSOR MAPS

MAP NO.: 2002-04 DRAWING: 2002-04 SHEET 4 OF 7

TOWN OF LAKEVIEW LOCAL WETLAND INVENTORY

T 39S R 20E SECTION 16

-  LAKEVIEW TOWN LIMITS
 -  URBAN GROWTH BOUNDARY
 -  WATERWAY
 -  TAX LOT BOUNDARY
 -  EXISTING ROAD R.O.W.
 -  OPEN WATER
 -  WETLAND AREA
 -  MOSAIC WETLAND AREA
 -  WETLAND LABEL
 -  FIELD VERIFIED
 -  YES
 -  NO
 -  POTENTIAL WETLAND
 -  DATA PLOT
 -  DATA PLOT LABEL
 -  STREAM OR DITCH
 -  DELINEATION FILE NO.
 -  EXCAVATED
- DET 03-0263
X

INFORMATION SHOWN OF THIS MAP IS FOR PLANNING PURPOSES ONLY AND WETLAND INFORMATION IS SUBJECT TO CHANGE. THERE MAY BE UNMAPPED WETLANDS SUBJECT TO REGULATION AND ALL WETLAND BOUNDARY MAPPING IS APPROXIMATE. IN ALL CASES, ACTUAL FIELD CONDITIONS DETERMINE WETLAND BOUNDARIES. YOU ARE ADVISED TO CONTACT THE OREGON DIVISION OF STATE LANDS AND THE U.S. ARMY CORPS OF ENGINEERS WITH ANY REGULATORY QUESTIONS.

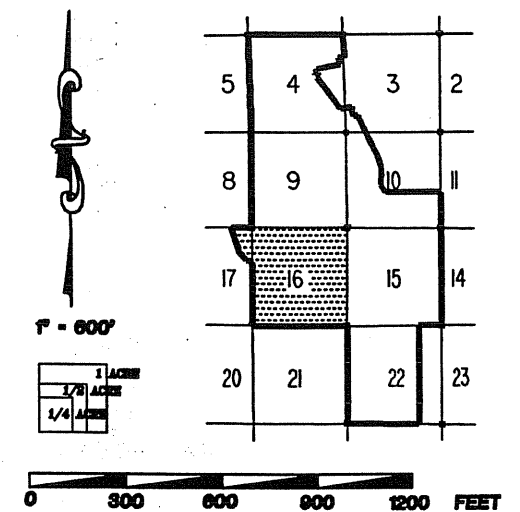

MAP PREPARED BY:

OCTOBER 31, 2002
REVISED JUNE 2003
REVISED JULY 2003



ANDERSON ENGINEERING AND SURVEYING, INC.
17681 HIGHWAY 395
LAKEVIEW, OR 97630
(541) 947-4407
FAX (541) 947-2321

JOB NO.: 2002-04

DRAWING: 2002-04

SHEET 5 OF 7

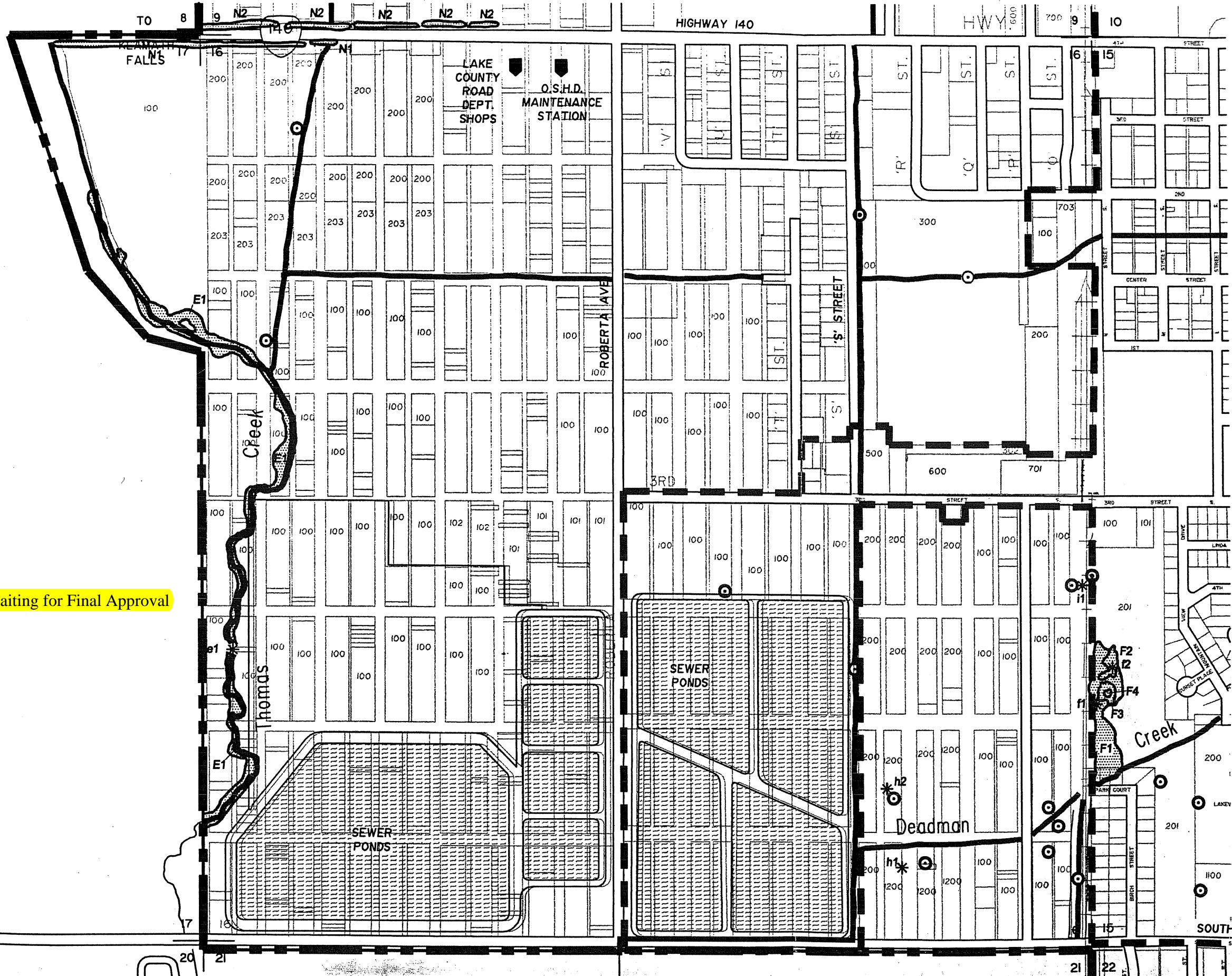











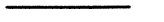

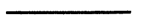
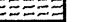

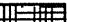

Waiting for Final Approval

MAPS BASED ON LAKE COUNTY ASSESSOR MAPS

TOWN OF LAKEVIEW LOCAL WETLAND INVENTORY

T 39S R 20E SECTION 15

-  LAKEVIEW TOWN LIMITS
-  URBAN GROWTH BOUNDARY
-  WATERWAY
-  TAX LOT BOUNDARY
-  EXISTING ROAD R.O.W.
-  OPEN WATER
-  WETLAND AREA
-  MOSAIC WETLAND AREA
-  WETLAND LABEL
-  FIELD VERIFIED
-  YES
-  NO
-  POTENTIAL WETLAND
-  DATA PLOT
-  DATA PLOT LABEL
-  STREAM OR DITCH
-  DELINEATION FILE NO.
-  EXCAVATED

INFORMATION SHOWN OF THIS MAP IS FOR PLANNING PURPOSES ONLY AND WETLAND INFORMATION IS SUBJECT TO CHANGE. THERE MAY BE UNMAPPED WETLANDS SUBJECT TO REGULATION AND ALL WETLAND BOUNDARY MAPPING IS APPROXIMATE. IN ALL CASES, ACTUAL FIELD CONDITIONS DETERMINE WETLAND BOUNDARIES. YOU ARE ADVISED TO CONTACT THE OREGON DIVISION OF STATE LANDS AND THE U.S. ARMY CORPS OF ENGINEERS WITH ANY REGULATORY QUESTIONS.

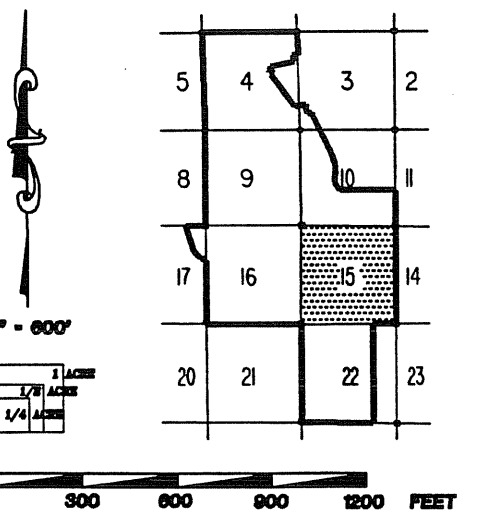

MAP PREPARED BY:

ANDERSON ENGINEERING AND SURVEYING, INC.
17681 HIGHWAY 395
LAKEVIEW, OR 97630
(541) 947-4407
FAX (541) 947-2321

OCTOBER 31, 2002
REVISED JUNE 2003
REVISED JULY 2003

JOB NO.: 2002-04 DRAWING: 2002-04 SHEET 6 OF 7

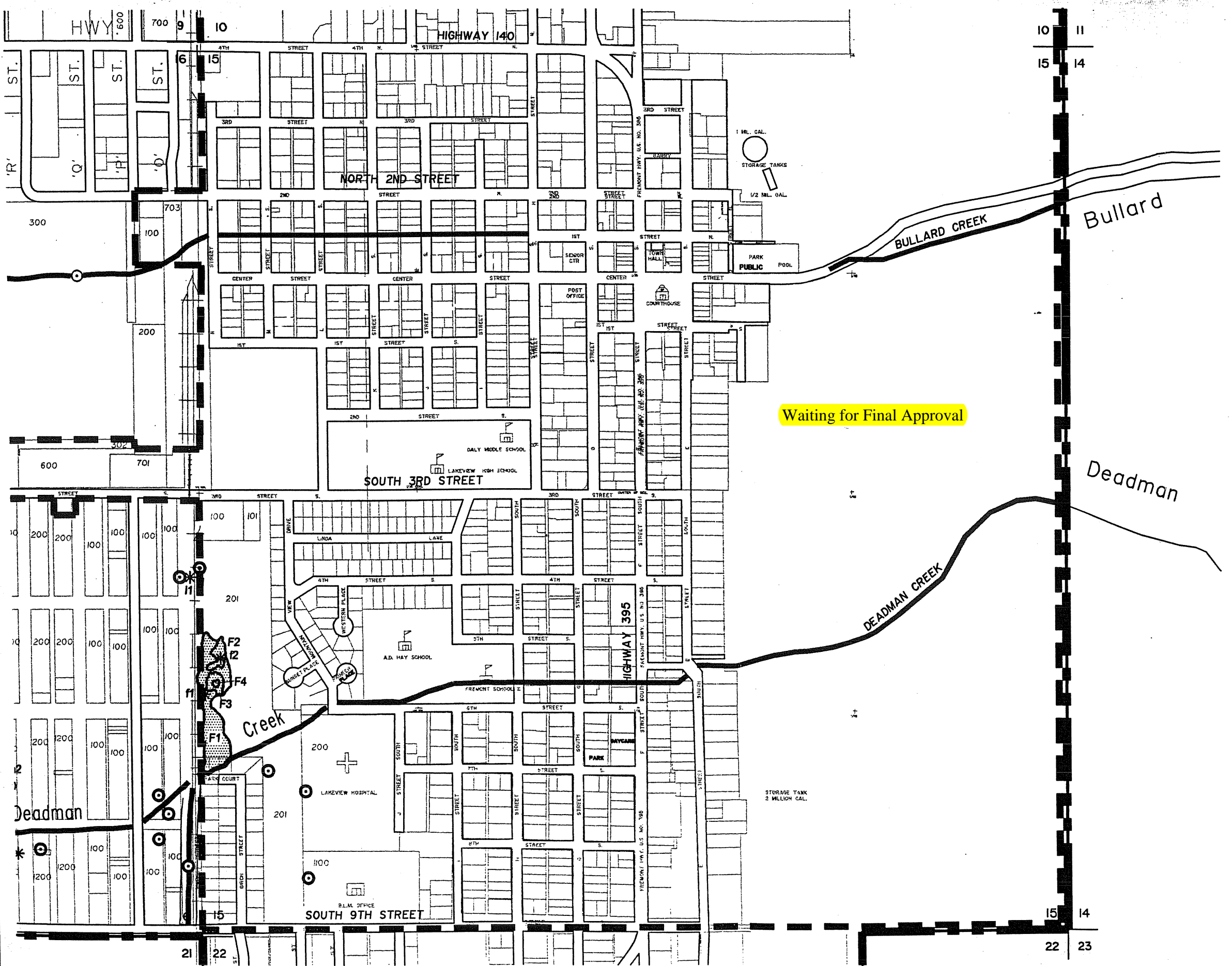



**TOWN OF LAKEVIEW
LOCAL WETLAND INVENTORY**

T 39S R 20E SECTION 22

- ■ ■ ■ LAKEVIEW TOWN LIMITS
- ■ ■ ■ URBAN GROWTH BOUNDARY
- WATERWAY
- TAX LOT BOUNDARY
- EXISTING ROAD R.O.W.
- ▨ OPEN WATER
- ▨ WETLAND AREA
- ▨ MOSAIC WETLAND AREA
- A1 WETLAND LABEL
- FIELD VERIFIED
- YES
- NO
- ⊙ POTENTIAL WETLAND
- * DATA PLOT
- a1 DATA PLOT LABEL
- STREAM OR DITCH
- DET 03-0263 DELINEATION FILE NO.
- X EXCAVATED

INFORMATION SHOWN OF THIS MAP IS FOR PLANNING PURPOSES ONLY AND WETLAND INFORMATION IS SUBJECT TO CHANGE. THERE MAY BE UNMAPPED WETLANDS SUBJECT TO REGULATION AND ALL WETLAND BOUNDARY MAPPING IS APPROXIMATE. IN ALL CASES, ACTUAL FIELD CONDITIONS DETERMINE WETLAND BOUNDARIES. YOU ARE ADVISED TO CONTACT THE OREGON DIVISION OF STATE LANDS AND THE U.S. ARMY CORPS OF ENGINEERS WITH ANY REGULATORY QUESTIONS.

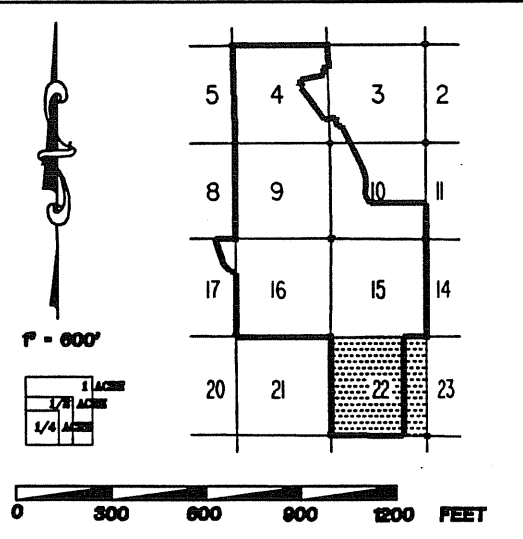

MAP PREPARED BY:

ANDERSON ENGINEERING AND SURVEYING, INC.
 17681 HIGHWAY 395
 LAKEVIEW, OR 97630
 (541) 947-4407
 FAX (541) 947-2321

JOB NO.: 2002-04 DRAWING: 2002-04 SHEET 7 OF 7

Waiting for Final Approval

22 | 23
 27 | 26

MAPS BASED ON LAKE COUNTY ASSESSOR MAPS

OCTOBER 31, 2002
 REVISED JUNE 2003
 REVISED JULY 2003